



PRIUS PLUG-IN HYBRID

2 0 1 3



QUICK REFERENCE GUIDE

2013 Prius Plug-in Hybrid

This *Quick Reference Guide* is a summary of basic vehicle operations. It contains brief descriptions of fundamental operations so you can locate and use the vehicle's main equipment quickly and easily.

The *Quick Reference Guide* is not intended as a substitute for the *Owner's Manual* located in your vehicle's glove box. We strongly encourage you to review the *Owner's Manual* and supplementary manuals so you will have a better understanding of your vehicle's capabilities and limitations.

Your dealership and the entire staff of Toyota Motor Sales, U.S.A., Inc. wish you many years of satisfied driving in your new Prius Plug-in Hybrid.

A word about safe vehicle operations

This *Quick Reference Guide* is not a full description of Prius Plug-in Hybrid operations. Every Prius Plug-in Hybrid owner should review the *Owner's Manual* that accompanies this vehicle.

Pay special attention to the boxed information highlighted in color throughout the *Owner's Manual*. Each box contains safe operating instructions to help you avoid injury or equipment malfunction.

All information in this *Quick Reference Guide* is current at the time of printing. Toyota reserves the right to make changes at any time without notice.

INDEX

OVERVIEW

Charge port	8
Engine maintenance	10
Fuel tank door release and cap	8
Hood release	9
Indicator symbols	4-5
Instrument cluster	4
Instrument panel	2-3
Keyless entry^{1,2}	6
Light control-Instrument panel	9
Smart Key system^{1,2}	7

ELECTRIC VEHICLE SYSTEM

Charging	12-16
Charging equipment	11
Charging system safety function	19
Electric Vehicle System	11
Inspecting electrical leakage detection function	18
Multi-Information	17
Display-Charging information	17
Plug-in Hybrid Applications	19

FEATURES/OPERATIONS

Air Conditioning/Heating	26
Audio	27
Auto lock/unlock^{1,2}	20
Clock	31
Cruise control	29
Dynamic Radar Cruise Control	30
EV/HV Mode	22
Garage door opener (HomeLink®) ³	31
Hill-start Assist Control (HAC)	31
Hybrid Synergy Drive System	20
Lights¹ & turn signals	25
Multi-Information Display²	29
Parking brake	22
Power outlets	28
Seat adjustments-Front	23
Seat heaters	26
Seats-Folding down rear seats	23
Seats-Head restraints	23
Steering wheel switches	28
Tilt and telescopic steering wheel	22
Transmission	21
Windows-Power	24
Wipers & washers	24

SAFETY AND EMERGENCY FEATURES

Doors-Child safety locks	33
Door locks	33
Floor mat installation	35
Seat belts	32
Seat belts-Shoulder belt anchor	32
Emergency tire puncture repair kit	33
Star Safety System™	34-35
Tire Pressure Monitoring (warning) System	32

¹ Visit your Toyota dealer for information on customizing this feature.

² Programmable by customer. Refer to the Owner's Manual for instructions and more information.

³ HomeLink® is a registered trademark of Johnson Controls, Inc.

OVERVIEW

Instrument panel

Steering wheel controls

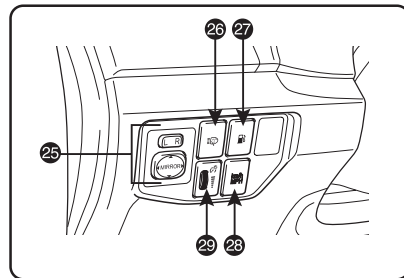
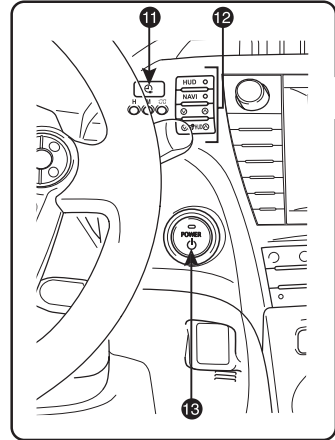
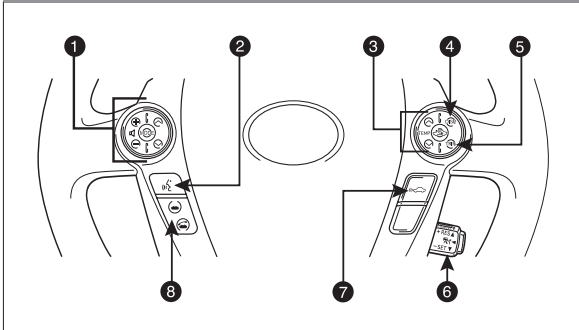

- ① Steering wheel audio controls^{2,3}
- ② Voice command button^{2,3}
- ③ Steering wheel climate controls
- ④ Multi-Information Display button
- ⑤ "TRIP" button
- ⑥ Cruise control¹/Dynamic Radar Cruise Control switch¹
- ⑦ Distance switch¹
- ⑧ Telephone controls²
- ⑨ Headlight and turn signal controls/Headlight, turn signal and front fog light controls¹
- ⑩ Wiper and washer controls
- ⑪ Charging timer switch
- ⑫ Head-Up Display switches¹
- ⑬ Power button
- ⑭ Multi-Information Display
- ⑮ Audio^{2,3}/Navigation system^{2,3,4}
- ⑯ Air Conditioning controls
- ⑰ Rear window and outside rearview mirror defogger button

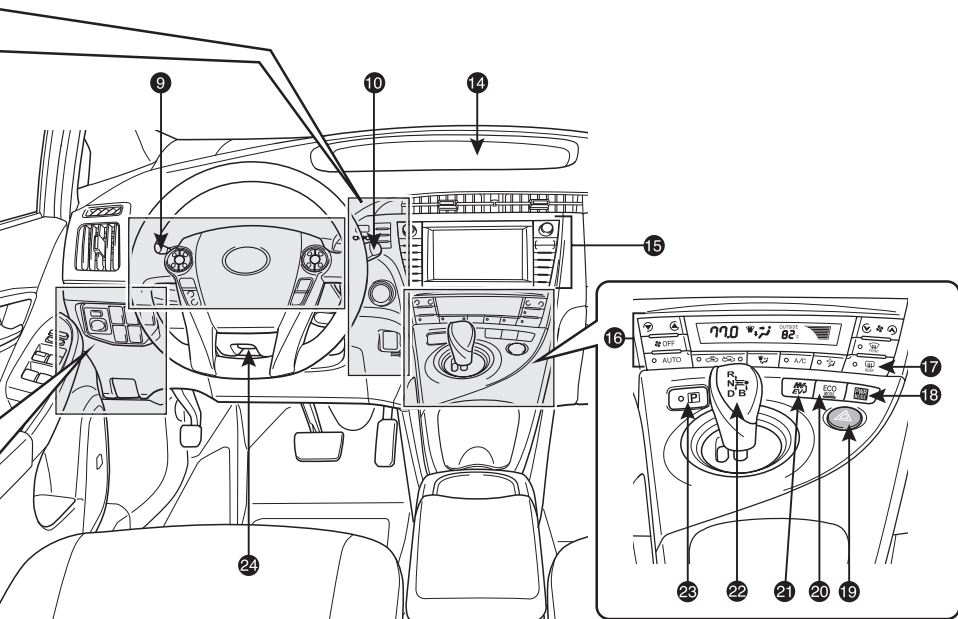

- 18 "PWR MODE" switch
- 19 Emergency flasher button
- 20 "ECO MODE" switch
- 21 "EV/HV" mode selection switch
- 22 Shift lever
- 23 "P" position switch
- 24 Tilt and telescopic steering lock release lever
- 25 Power rearview mirror controls
- 26 Headlight cleaner switch¹
- 27 Fuel filler door opener
- 28 Mph or km/h button
- 29 Instrument panel light control

¹ If equipped

² For details, refer to the "Navigation System Owner's Manual."

³ For details, refer to the "Display Audio System Owner's Manual."

⁴ For details, refer to the "Navigation System with Entune Quick Reference Guide."

Instrument cluster

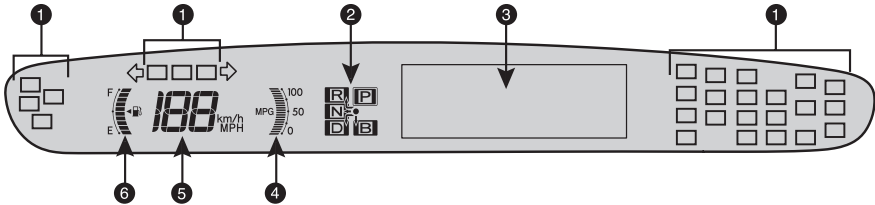

- 1 Service indicators and reminders
- 2 Transmission shift position indicator
- 3 Multi-Information Display
- 4 Instantaneous fuel consumption
- 5 Speedometer
- 6 Fuel gauge

Indicator symbols

For details, refer to “Indicators and warning lights,” Section 2-2, 2013 Owner’s Manual.

Brake system warning¹

Brake system warning light (yellow indicator)¹

Driver seat belt reminder
(alarm will sound if speed is over 12 mph)

PASSENGER

AIRBAG OFF

AIRBAG ON

Front passenger seat belt reminder
(alarm will sound if speed is over 12 mph)

Charging system warning¹

PASSENGER

AIRBAG OFF

AIRBAG ON

Front passenger occupant classification indicator

Malfunction/Check engine indicator¹

Low fuel level warning

Open door warning

Airbag SRS warning¹

Master warning¹

Low tire pressure warning¹

¹ If indicator does not turn off within a few seconds of starting Hybrid System, there may be a malfunction. Have vehicle inspected by your Toyota dealer.

	Electric power steering system warning ¹
	Immobilizer system indicator
	Headlight low/high beam indicator
	Turn signal indicator
	READY indicator
	ECO Driving Indicator Light
	EV indicator
	EV Drive Mode indicator
	ECO Mode indicator
	POWER Mode indicator
	Front fog light indicator
	Slip indicator/Hill-start Assist Control indicator ¹
	Cruise control indicator ^{2,3}
	Cruise control SET indicator
	Radar cruise control indicator ³
	Charging timer indicator
	Anti-lock Brake System warning ¹
	Automatic headlight leveling system warning ¹
	Pre-Collision System warning ¹
	High coolant temperature warning ¹

² If this light flashes, refer to “Cruise control,” Section 2-4, 2013 Owner’s Manual.

³ If this light flashes, refer to “Dynamic radar cruise control,” Section 2-4, 2013 Owner’s Manual.

Keyless entry

Locking operation

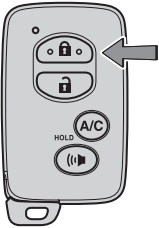

Push 

Unlocking operation

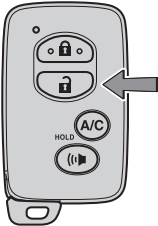

Push ONCE: Driver door
TWICE: All doors 

NOTE: If a door is not opened within 60 seconds of unlocking, all doors will relock for safety.

Remote Air Conditioning system operation

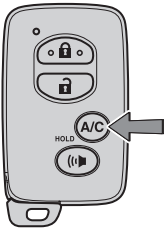

Will automatically shut off after 10 minutes, or if a door is opened.

Push and hold 

Panic button



Push and hold 

Smart Key system

Start function

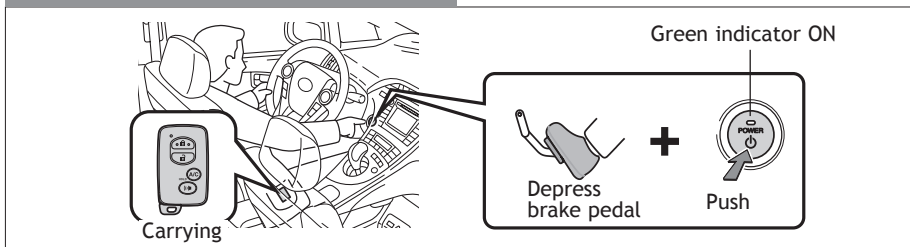

Power (without starting Hybrid System)

Without depressing the brake pedal, pressing the “POWER” switch will change the operation mode in succession from:

ACCESSORY

Accessories such as the radio will operate.

ON

Power ON; Hybrid System is not engaged.

OFF

All systems OFF.

Locking

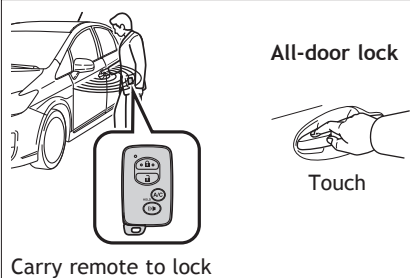

Unlocking

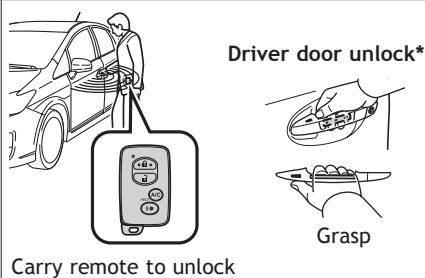

Back door lock/unlock

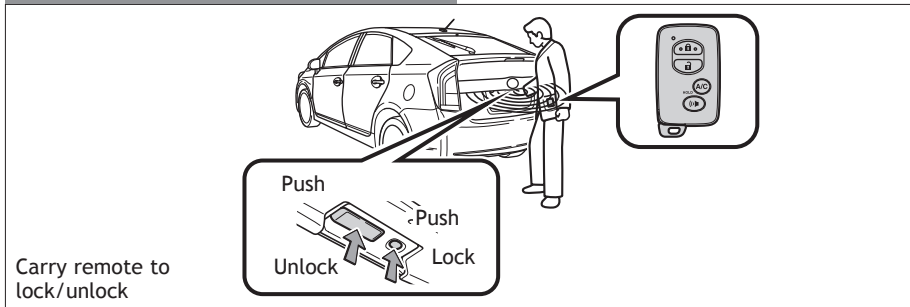

* Driver door unlocking function can be programmed to unlock driver door only, or all doors. Grasping passenger door handle or pushing unlock button on rear hatch will unlock all doors. (If equipped)

NOTE: Doors may also be locked/unlocked using remote.

Fuel tank door release and cap

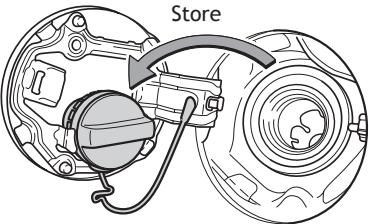
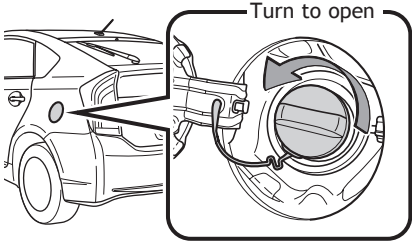
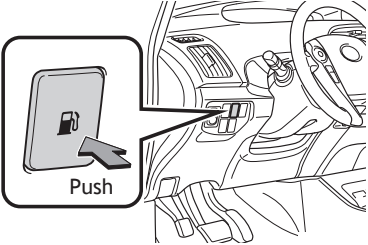

NOTE: Tighten until one click is heard. If the cap is not tightened enough, Check Engine “” indicator may illuminate.

Charge port

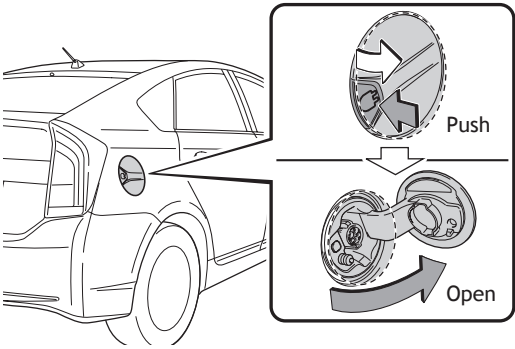

Refer to the *Owner’s Manual* for more details.

Hood release

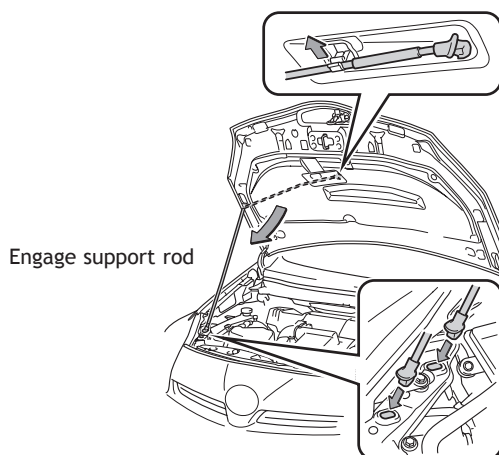
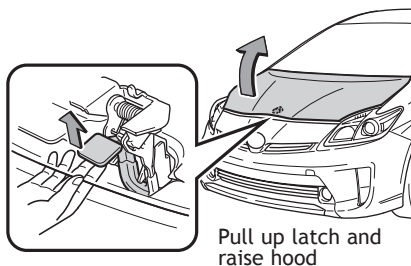
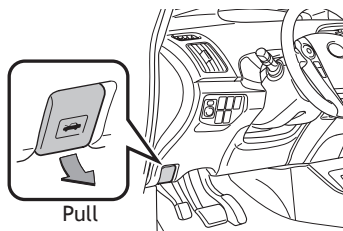

Light control-Instrument panel

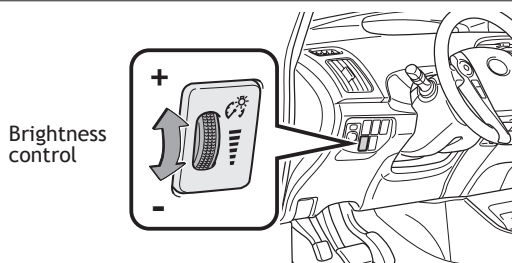

Engine maintenance

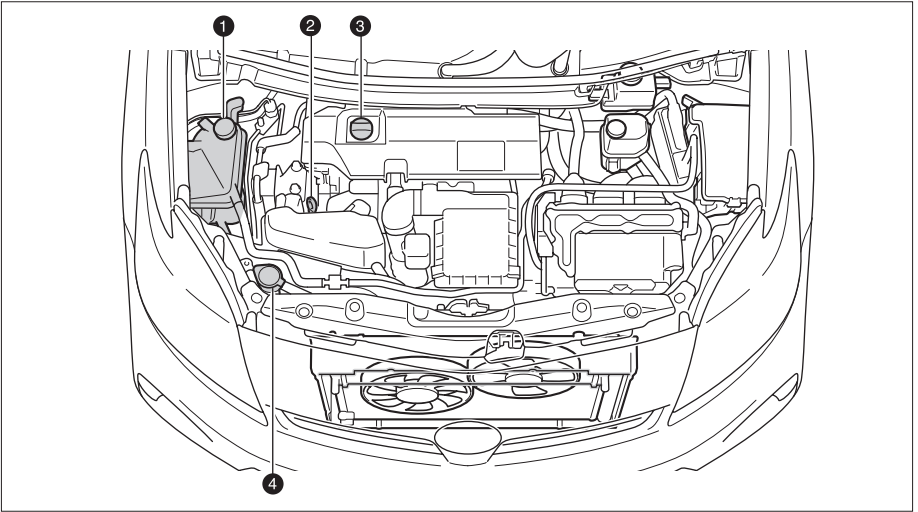

- ① Engine coolant reservoir
- ② Engine oil level dipstick
- ③ Engine oil filler cap
- ④ Windshield washer fluid tank

NOTE: Regularly scheduled maintenance, including oil changes, will help extend the life of your vehicle and maintain performance. Please refer to the “Warranty & Maintenance Guide.”

ELECTRIC VEHICLE SYSTEM

OVERVIEW

ELECTRIC VEHICLE SYSTEM

FEATURES/OPERATIONS

SAFETY AND EMERGENCY FEATURES

Electric Vehicle System

The Prius Plug-in Hybrid system has features of both electric and hybrid vehicles. Electricity received by charging from an external power source can be used to supplement hybrid energy, and the vehicle can also be driven as an electric vehicle using only the electric motor. The EV driving range can be extended by using regenerative braking to store electricity in the traction battery.

Charging equipment

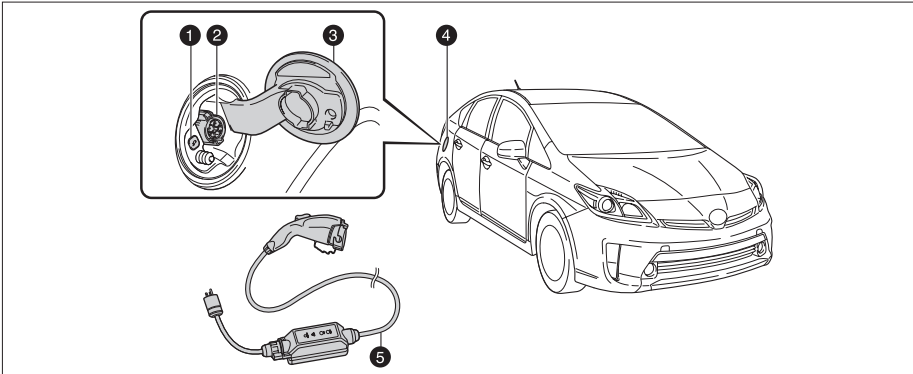

- 1 Charging indicator
- 2 Charging inlet
- 3 Charging port lid
- 4 Charging port
- 5 Charging cable

The charging cable included with the vehicle is designed to be connected only to an AC 120V power source.

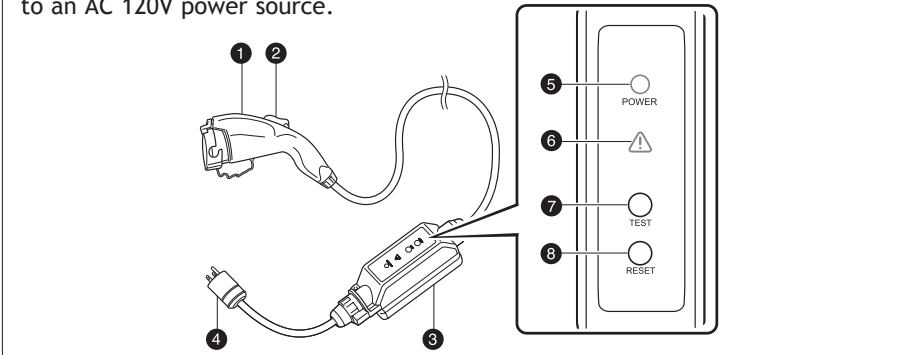

- 1 Charging connector
- 2 Latch release button
- 3 CCID (Charging Circuit Interrupting Device)
- 4 Plug
- 5 Power indicator
- 6 Error warning indicator
- 7 Test button
- 8 Reset button

Charging

The Prius PHV may be charged immediately, or scheduled to charge at a specific time. Before charging, it is recommended that:

- Parking brake is securely set
- All lights are turned off
- The POWER switch is OFF

Start charging

Step 1 Plug the charging cable into the outlet of the external power source.

NOTE: Hanging the CCID on a hook is recommended to reduce the strain on the outlet and charging cable plug.

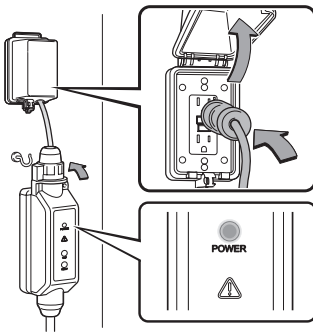

- Make sure to hold the body of the plug and insert it firmly into the outlet.
- Check that the power indicator of the CCID (Charging Circuit Interrupting Device) is illuminated.
- The surface of the CCID may become hot, but this does not indicate a malfunction.

Step 2 Press the test button on the CCID to check that the electrical leakage detection function operates properly.

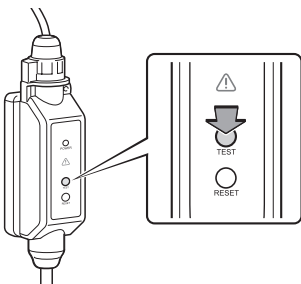

- If the error warning indicator illuminates when test button is pressed, the function is operating correctly.
- After the test is completed, press reset button to turn off the error warning. Charging cannot occur while error warning is illuminated.
- If the error warning indicator does not come on when test button is pressed, the function may not be operating correctly. Stop charging immediately and contact your Toyota dealer.

Step 3 Press the charging port lid to open.

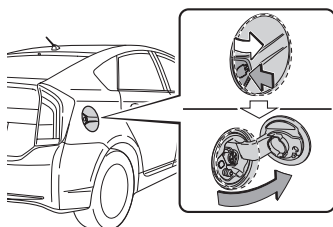

The charging inlet light will illuminate.

Step 4 Remove the charging connector cap. Affix the cap to the cable.

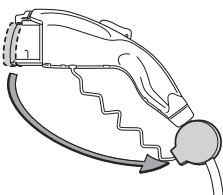

Step 5 Insert the charging cable connector into the charging inlet.

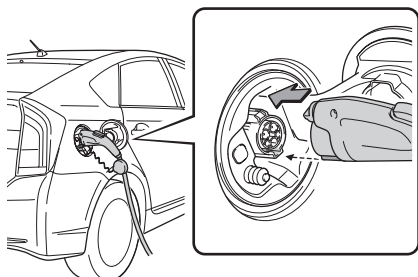

- Do not press the latch release button when inserting the connector.
- Align with the guide position shown on underside of the charging connector, and push it in until it clicks.

Step 6 Confirm that the charging indicator is illuminated. (When the charging timer function is in use, the light will turn off several seconds after illuminating.)

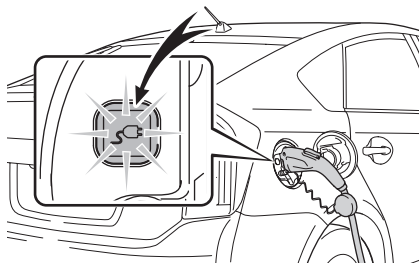

- Charging will not start if the charging indicator does not illuminate when the charging connector is inserted.
- The amount of time until charging is completed can be checked on the energy monitor by turning the POWER switch to ON mode.
- The charging indicator will turn off when charging is completed.

Refer to the *Owner's Manual* for more details.

Charging timer

Use of the charging timer can suppress deterioration of the hybrid battery (traction battery) and off-peak electricity can be used effectively.

Set the charging timer

Step 1 Stop the vehicle and press the charging timer switch.

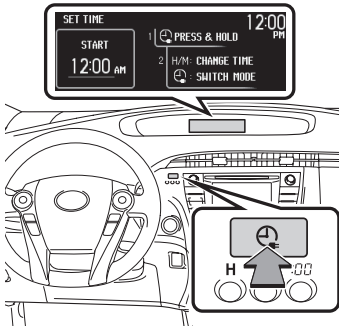

The Multi-Information Display will switch to the charging timer display.

Step 2 Press and hold the charging timer switch.

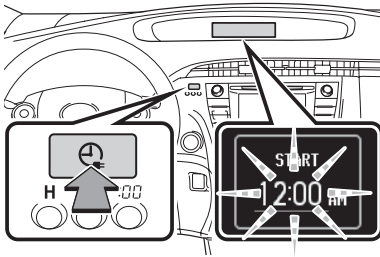

The timing display will change from solid to flashing.

Step 3 Press the charging timer switch to select the setting mode.

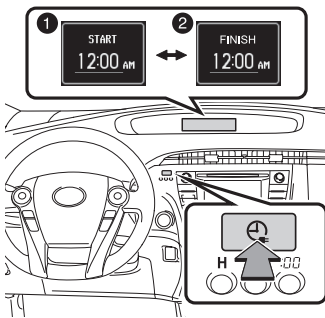

- ① Start time setting mode
- ② Finish time setting mode

The mode will switch with each press of the charging timer switch.

Step 4 Adjust the set time using the time adjustment button.

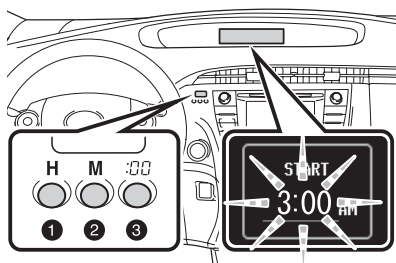

- ① Adjust hours
- ② Adjust minutes
- ③ Round to the nearest hour*

* Example: 1:00 to 1:29 -> 1:00
1:30 to 1:59 -> 2:00

Step 5 Press and hold the charging timer switch.

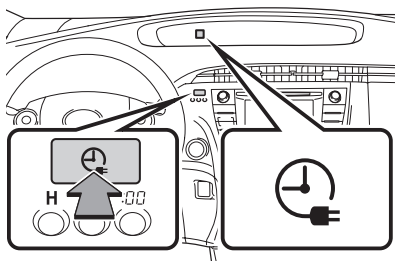

Once set, the time display will change from flashing to solid, and the charging timer indicator on the instrument cluster will come on.

Step 6 Turn the POWER switch off.

The charging time indicator will start flashing.

Step 7 Connect the charging cable to the vehicle.

Check that the charging indicator has come on. It will turn off after several seconds. If the indicator does not come on, re-insert the charging connector. If it still does not come on, check the power supply status using the power indicator on the CCID (Charging Circuit Interrupting Device).

Cancelling charging timer

If the charging timer switch is pressed while the charging timer indicator is illuminated or flashing, the charging timer function will be canceled. Charging will commence immediately if the charging cable is connected to the vehicle.

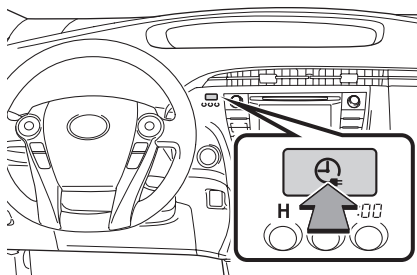

The charging timer indicator will turn off if the charging timer function is canceled.

ELECTRIC VEHICLE SYSTEM

After charging

Step 1 Pull the charging connector toward you while pressing the latch release button.

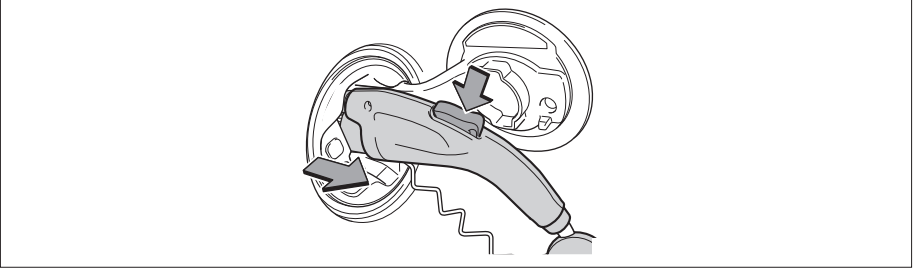

Step 2 Attach the charging connector cap.

Step 3 Close the charging port lid.

Step 4 Remove the plug from the outlet when the charging equipment will not be used for a long period of time.

Hold the body of the plug when removing. Make sure to put the cable away immediately after disconnecting.

Multi-Information Display-Charging information

Remaining charging time Charging information is displayed on the Multi-Information Display.

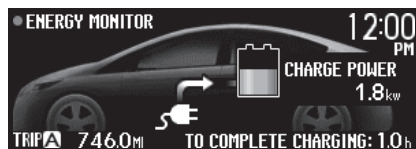

If the POWER switch is turned to ON mode during charging, the current charging status and the amount of time needed until charging is complete will be displayed on the energy monitor.

After confirming, switch the POWER switch to OFF and turn off the display. The POWER switch will turn off automatically after several tens of seconds.

Charging information and warning messages The first time the POWER switch is turned to ON mode after charging is completed, a message detailing the results of the charge is shown. Also, if an operation that cannot be carried out during charging was attempted, a warning message will be shown.

CHARGE RESULT:
CHARGE COMPLETE

Follow the instructions in the message. The message may not be displayed if the Remote Air Conditioning System has been used.

See the *Owner's Manual* for more details.

Inspecting electrical leakage detection function

As a precaution, inspect the charging cable on a routine basis (at least once a month).

Check that the electrical leakage detection function is operating properly by following the procedure below.

In the unlikely event that the electrical leakage detection function is not operating properly, contact your Toyota dealer as soon as possible.

Step 1 Insert the charging cable into the outlet of the external power source.

Step 2 Press the test button on the CCID (Charging Circuit Interrupting Device).

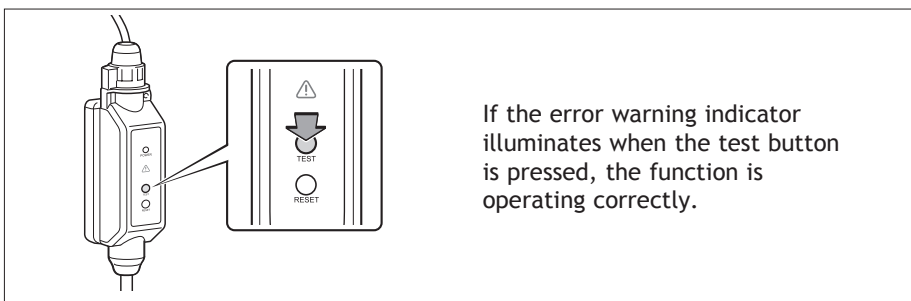

Step 3 Press the reset button on the CCID (Charging Circuit Interrupting Device).

Turn off the error warning indicator. Charging cannot be carried out while the error warning indicator is illuminated.

Charging can be continued by following the normal procedure. If not charging, store the charging cable.

See the *Owner's Manual* for important precautionary information.

Charging system safety functions

- The Hybrid System will not start while the charging cable is attached to the vehicle, even if the POWER switch is operated.
- If the charging cable is connected while the READY indicator is illuminated, the Hybrid System will stop automatically and driving will not be possible.
- When the charging cable is connected to the vehicle, the shift position cannot be changed from P to another position.
- If the latch release button is pressed, charging will not begin even if the charging cable is connected.
- Charging will stop if the latch release button is pressed and held for several seconds during charging. When restarting charging, reinsert the charging connector after pulling it out, and check that the charging indicator illuminates.

Plug-in Hybrid Applications

Plug-in Hybrid Applications is a service for plug-in hybrid vehicles that is added to the Safety Connect® and Entune® products. It provides charge support, comfort support and drive support via the vehicle's navigation system and the owner's smartphone.

Both an active Safety Connect® account and an active Entune® account are required for the services.

The following functions of the Plug-in Hybrid Applications can be used with the navigation system:

Type A Download of nearby charging stations to the map screen.

Type B View list of nearby charging stations and corresponding charging station information (such as voltage supported).

For details, please refer to <http://www.toyota.com/entune>.

FEATURES/OPERATIONS

Hybrid Synergy Drive System

The Hybrid Synergy Drive System utilizes a computer-controlled gasoline engine and electric motor to provide the most efficient combination of power for the vehicle. To conserve energy, when the brakes are applied the braking force generates electricity which is then sent to the traction battery. In addition, the engine shuts off when the vehicle is stopped. The benefits are better fuel economy, reduced vehicle emissions and improved performance.

NOTE: Fuel consumption and energy information of the Hybrid System are shown on the Multi-Information Display.

Tips for improved fuel economy

- Ensure tire pressures are maintained at levels specified in the *Owner's Manual*.
- When possible, link trips to reduce engine cold starts.
- Avoid driving at speeds that are higher than necessary, especially on the highway.
- When possible, avoid sudden stops to maximize regenerative braking energy.
- Minimize use of the Air Conditioning.

Starting your vehicle



- (1) Depress the brake pedal, and press the “POWER” switch briefly and firmly.
- (2) The “READY” light will blink. After a few seconds, when the light remains steady and a beep sounds, you may begin driving.

Auto lock/unlock

Automatic door locks can be programmed to operate in two different modes, or turned OFF.

- Doors lock when shifting from Park.
- Doors lock when the vehicle speed is approximately 12 mph or higher.
- Doors unlock when shifting into Park.
- Doors unlock when the driver's door is opened within 10 seconds after turning the “POWER” switch OFF.

Refer to the *Owner's Manual* for more details.

Transmission

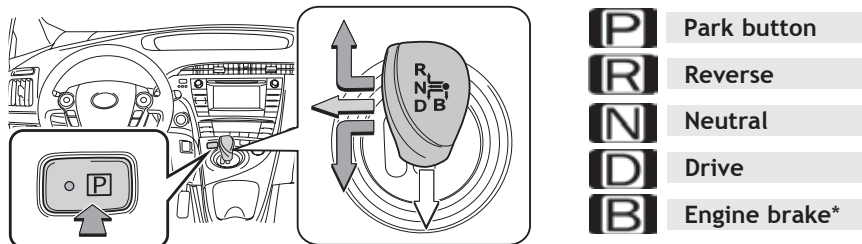

* The engine brake is the equivalent of downshifting. Shift to “B” when engine braking is desired (i.e. downhill driving, coasting to a stop, etc.).

ECO Mode

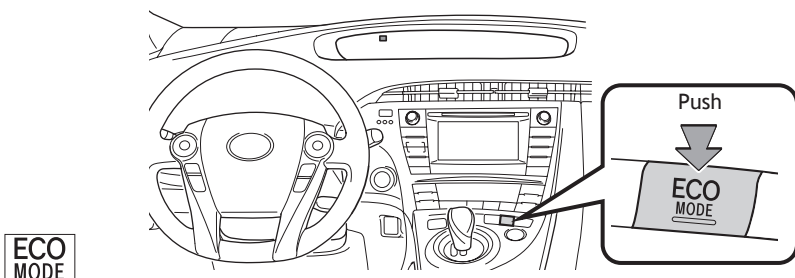

ECO Mode helps achieve low fuel consumption during trips that involve frequent accelerating and braking.

Refer to the *Owner's Manual* for more details.

POWER Mode

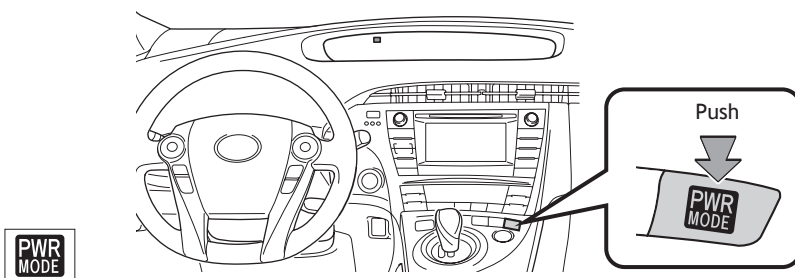

Use when a higher level of response is desired, such as when driving in mountainous regions.

Refer to the *Owner's Manual* for more details.

EV/HV Mode

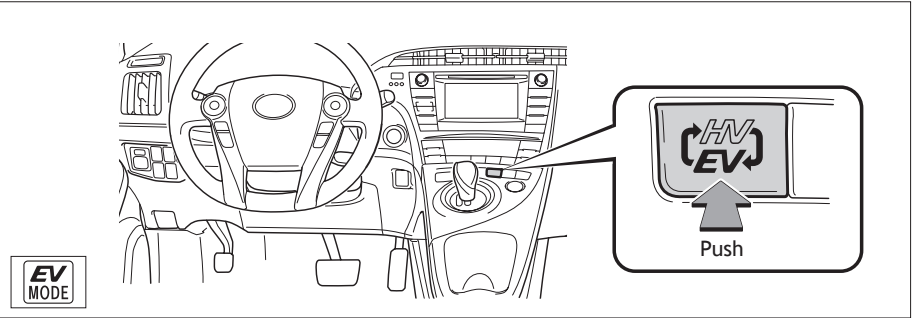

EV/HV Mode allows the electric motor (traction motor), powered by the hybrid battery (traction battery), to be used to drive the vehicle under certain driving conditions.

Refer to the *Owner's Manual* for more details.

Tilt and telescopic steering wheel

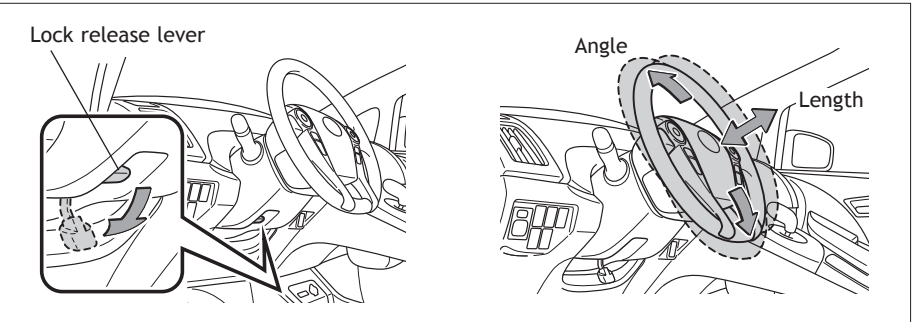

Hold wheel, push lever down, set angle and length, and return lever.

NOTE: Do not attempt to adjust while the vehicle is in motion.

Parking brake

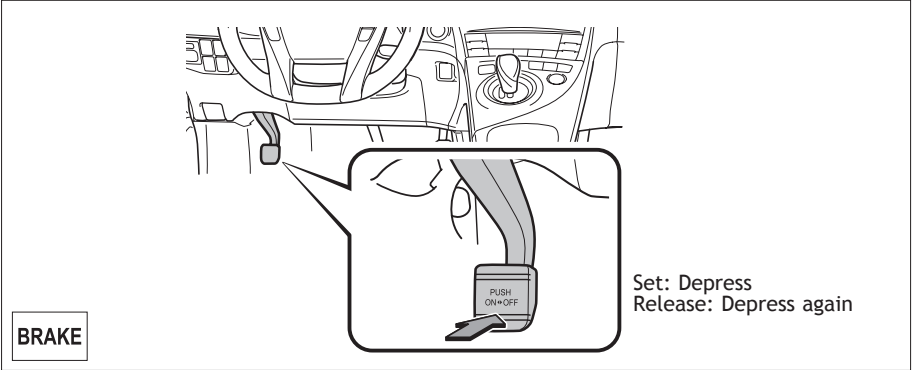

Seat adjustments-Front

Manual seat

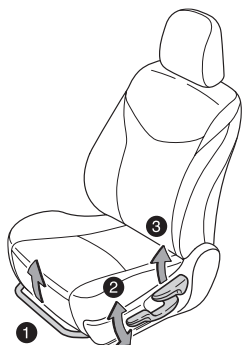

Power seat (driver side only)*

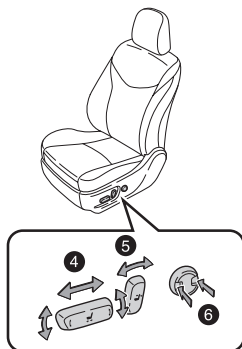

* If equipped

- ① Seat position (forward/backward)
- ② Height crank (driver side only)
- ③ Seatback angle
- ④ Seat position, cushion angle and height
- ⑤ Seatback angle
- ⑥ Lumbar support

Seats-Head restraints

Front

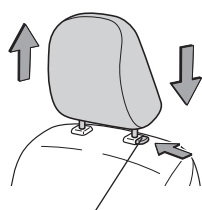

Lock release button

Rear center

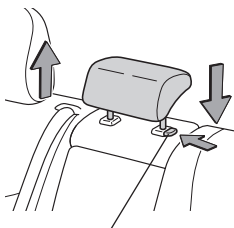

Lock release button

Rear outboard

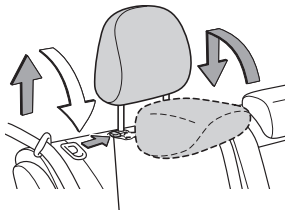

Lock release button

Seats-Folding down rear seats

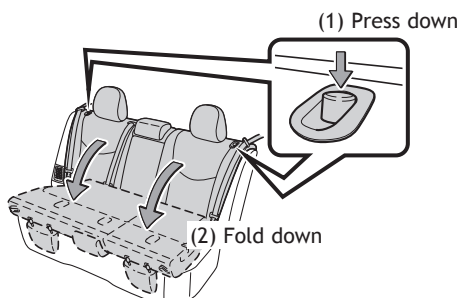

Windows-Power

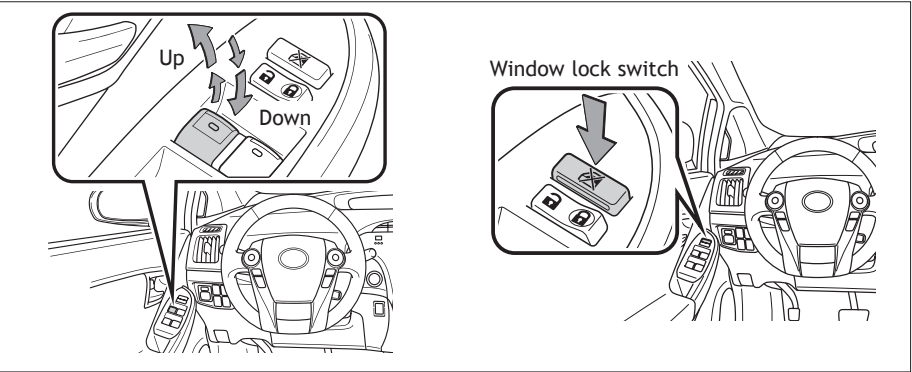

Automatic operation Push the switch completely down or pull it completely up and release to fully open or close. To stop the window partway, operate the switch in the opposite direction.

Window lock switch Deactivates all passenger windows. Driver's window remains operable.

Wipers & washers

Front

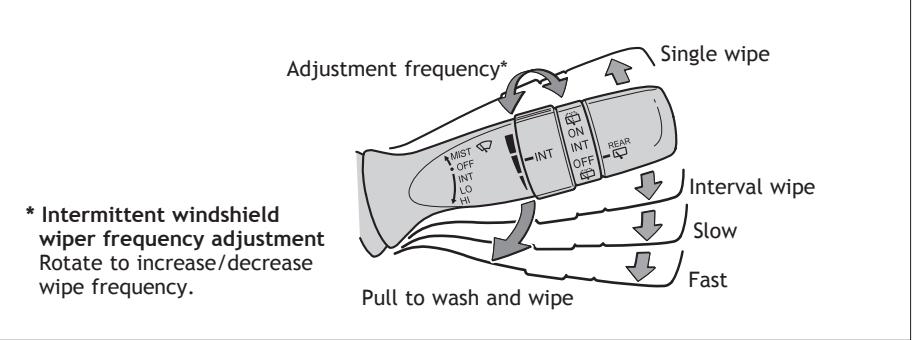

Rear

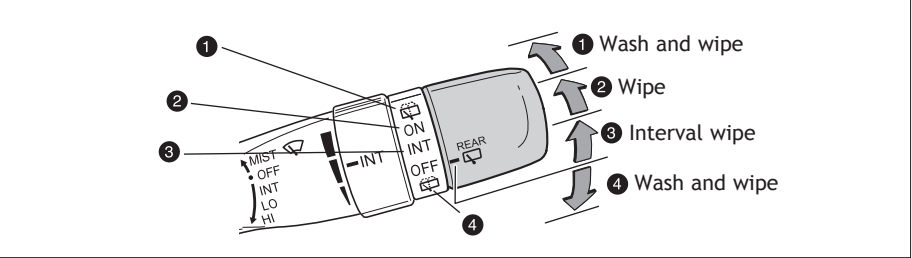

Lights & turn signals

Headlights

Type A

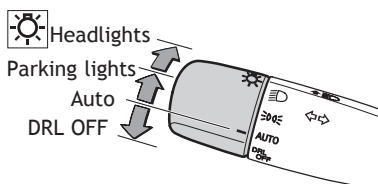

Type B

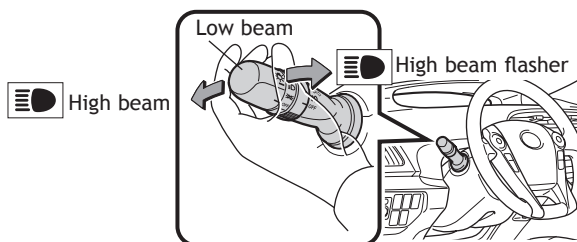
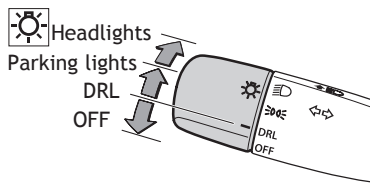

Automatic light cutoff system Automatically turns lights off after a delay of 30 seconds, or when lock switch on remote is pushed after all doors are locked.

Front fog lights (if equipped)

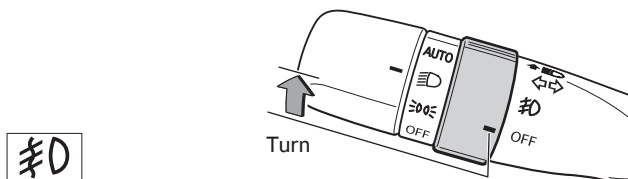

Front fog lights come on only when the headlights are on low beam.

Turn signals

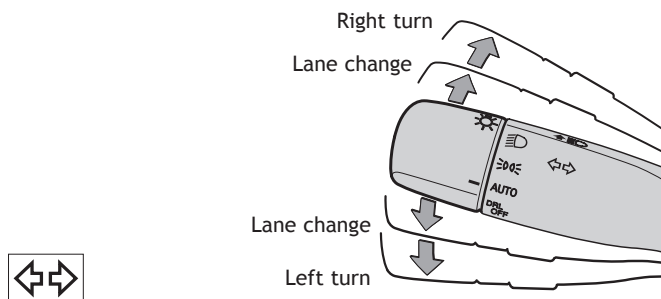

Seat heaters

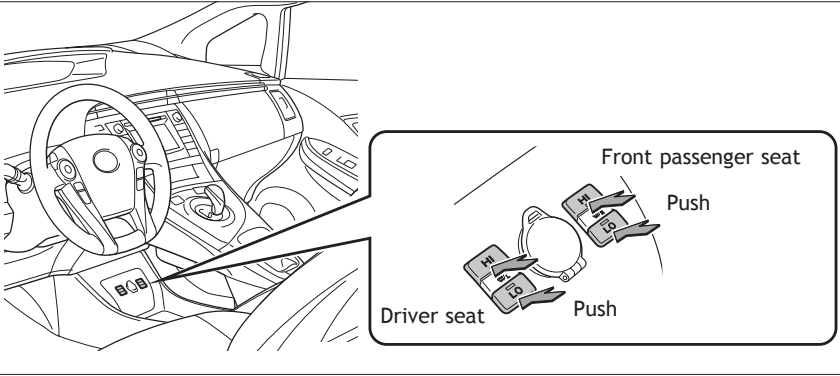

Air Conditioning/Heating

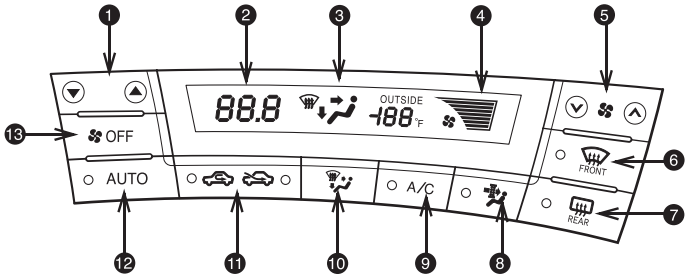

- 1 Temperature selector
- 2 Temperature setting display
- 3 Air outlet display
- 4 Fan speed display
- 5 Fan speed control
- 6 Windshield defogger
- 7 Rear defogger
- 8 Micro dust and pollen filter mode (turns off automatically after 3 minutes)
- 9 Air Conditioning ON/OFF
- 10 Airflow vent
Use “” or “” mode to reduce window fogging.
- 11 Air intake control (switch between outside air and recirculated air mode)
- 12 Automatic climate control ON
Adjusting the temperature setting will cause the airflow vents, air intake and fan to adjust automatically.
- 13 Climate control OFF

Audio

Type 1¹

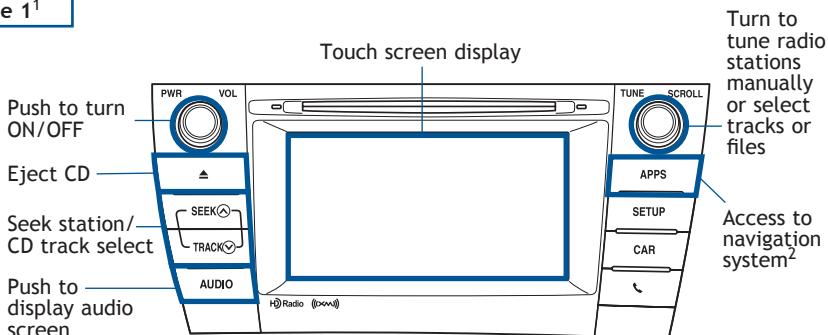

Type 2 (additional functions)³

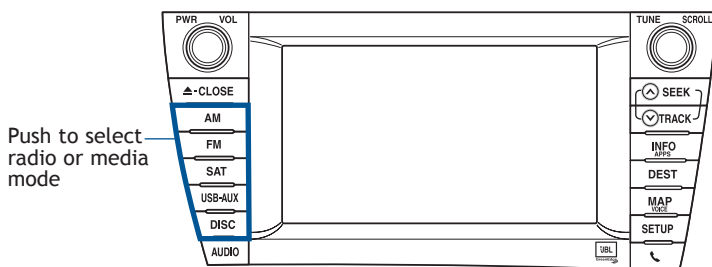

¹ Refer to the "Display Audio System Owner's Manual."

² Refer to the "Navigation System with Entune Quick Reference Guide."

³ Refer to the "Navigation System Owner's Manual."

USB/AUX port

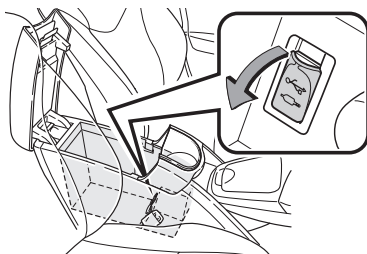

By inserting a mini plug into the USB/AUX port, you can listen to music from a portable audio device through the vehicle's speaker system while in USB/AUX mode.

Power outlets

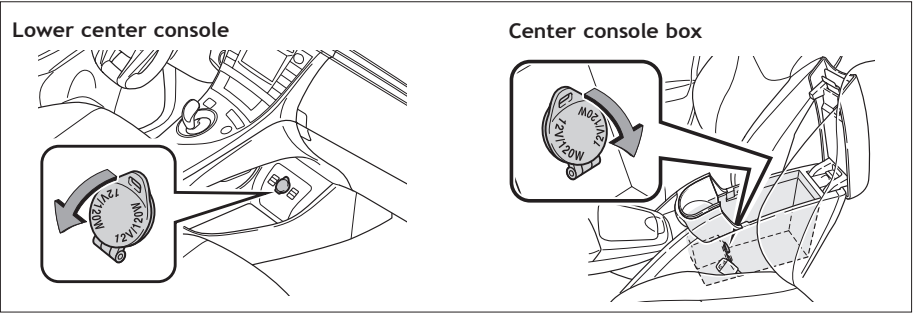

Power switch must be set at “ACCESSORY” or “ON” in order to use power outlets.

Steering wheel switches

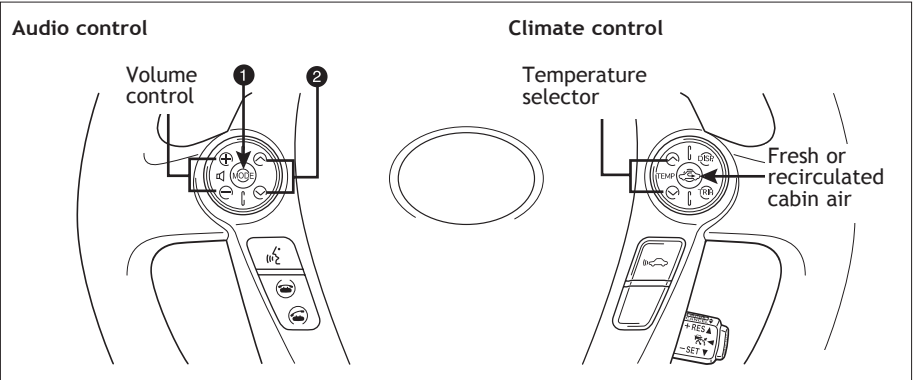

- 1 “MODE”
Push to turn audio ON and select an audio mode. Push and hold to mute/unmute or pause/resume the current operation.
- 2 “V A”
Use to search within the selected audio medium (radio, CD, iPod®, etc.).

Multi-Information Display

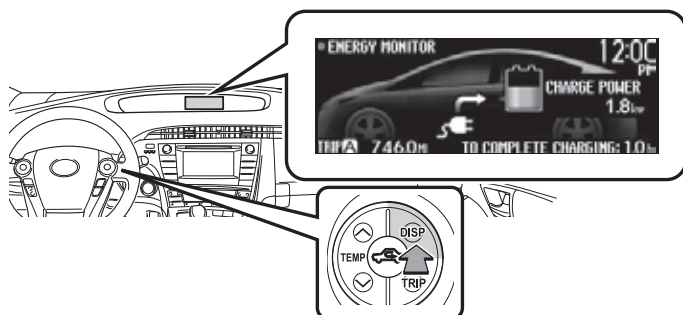

Push “DISP” to change between the following information screens:

- (1) Energy monitor
- (2) Hybrid System indicator
- (3) 5-minute/1-minute interval fuel consumption display
- (4) Fuel consumption history display
- (5) EV driving ratio

Push and hold “DISP” to set up the displays.

Cruise control

Turning system ON/OFF

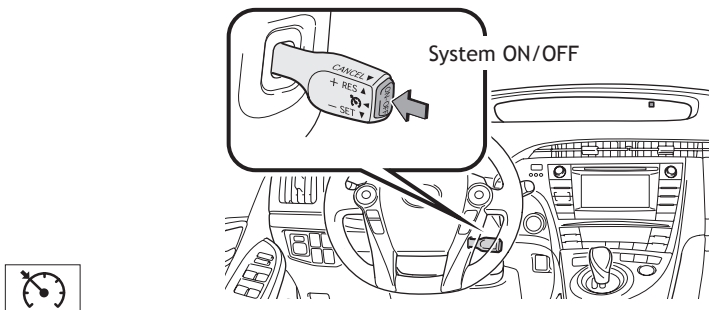

Functions

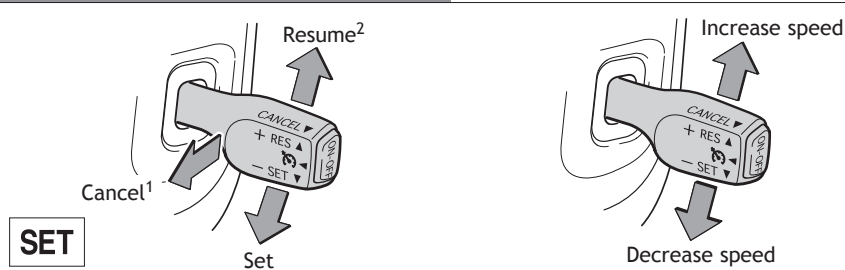

¹ The set speed may also be cancelled by depressing the brake pedal.

² The set speed may be resumed once vehicle speed exceeds 25 mph.

**Dynamic Radar Cruise Control
(if equipped)**

Refer to the *Owner’s Manual* for more details and complete safety precautions before attempting to use “Dynamic Radar Cruise Control.”

Fixed speed mode

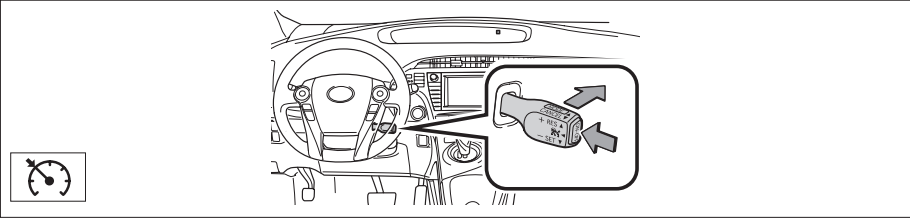

- (1) **To select conventional/fixed speed control** Push the ON-OFF button. Push the lever forward and hold until the “” indicator appears.
- (2) **To set, cancel and resume a speed** Refer to instructions in the *Cruise control* section.

Distance control mode

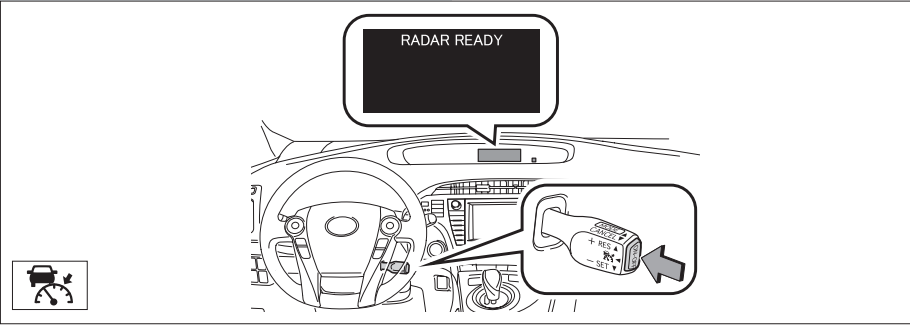

In distance control mode, vehicle will cruise at a set speed, decelerate to maintain selected distance from a slower vehicle traveling in front, and accelerate back up to the selected speed if the vehicle in front changes lanes or speeds up.

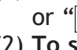
- (1) **To select distance control mode** Push the ON-OFF button. The “RADAR READY” or “” will come on.
- (2) **To set, cancel or resume a speed** Refer to instructions in the *Cruise control* section.

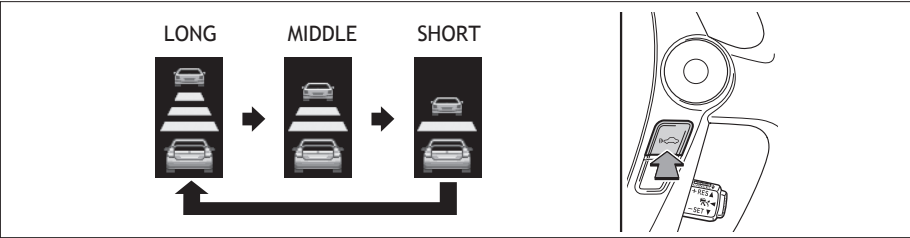

- (3) **To change the vehicle-to-vehicle distance**
Push the distance button to cycle through the settings, which will change progressively from LONG to MIDDLE to SHORT.

Clock

H- Hour set
M- Minute set
:00- Round off
minutes

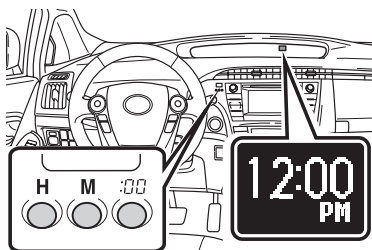

Refer to the *Owner's Manual* for details on adjusting time.

Hill-start Assist Control (HAC)

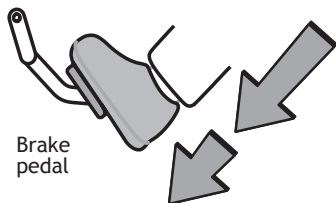

Brake
pedal

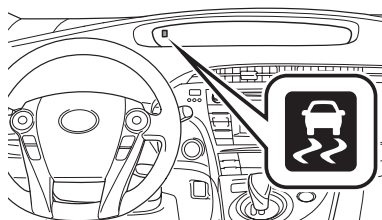

HAC helps prevent rolling backwards on an incline. To engage, push further down on brake pedal while at a complete stop until a beep sounds and slip indicator illuminates. HAC holds for approximately two seconds after releasing brake pedal.

Refer to the *Owner's Manual* for more details.

Garage door opener (HomeLink®)* (if equipped)

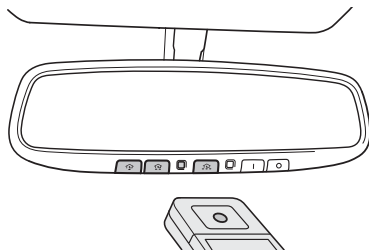

Garage door openers manufactured under license from HomeLink®* can be programmed to operate garage doors, estate gates, security lighting, etc.

Refer to “Garage door opener,” Section 3-5 in the *Owner's Manual* for more details.

For programming assistance, contact HomeLink® at 1-800-355-3515, or visit <http://www.homelink.com>.

* HomeLink® is a registered trademark of Johnson Controls, Inc.

SAFETY AND EMERGENCY FEATURES

Seat belts

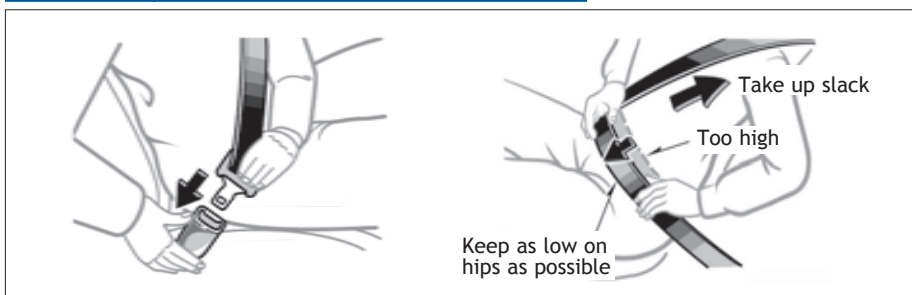

If belt is fully extended, then retracted even slightly, it cannot be re-extended beyond that point, unless fully retracted again. This feature is used to help hold child restraint systems securely.

To find more information about seat belts, and how to install a child restraint system, refer to the *Owner's Manual*.

Seat belts-Shoulder belt anchor

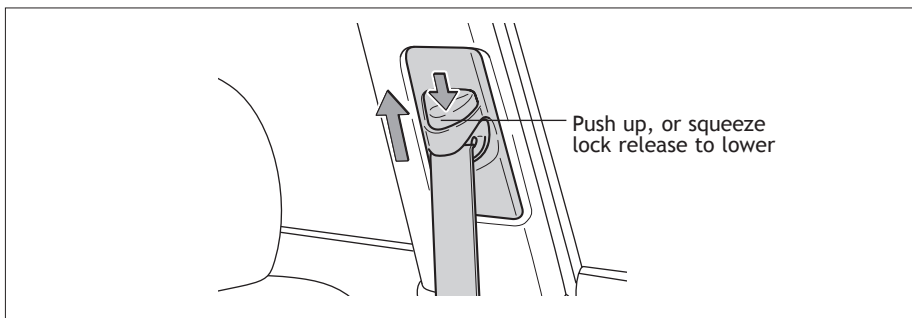

Tire Pressure Monitoring (warning) System

If the Tire Pressure Warning indicator “” illuminates without blinking, adjust tire pressures to factory-specified levels.* The light will turn off after a few minutes. The warning light is designed to turn on when tire pressure is critically low, but it may also come on due to temperature changes or changes in tire pressure from natural air leakage.

If the tire pressure indicator flashes for more than 60 seconds and then remains on, take the vehicle to your local Toyota dealer.

Refer to the *Owner's Manual* for more details.

* Refer to load label on door jamb or the *Owner's Manual* for tire inflation specifications.

Door locks

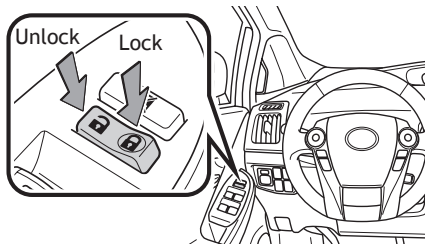

Doors-Child safety locks

Rear door

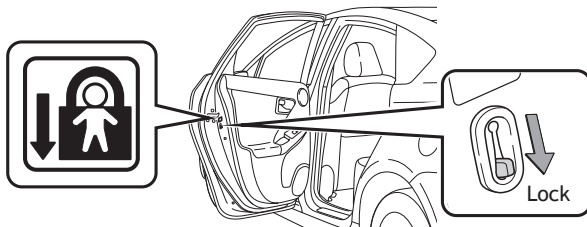

Moving the lever to lock position will allow the door to be opened only from the outside.

Emergency tire puncture repair kit

Tool location

Side deck board

Emergency tire
puncture repair kit

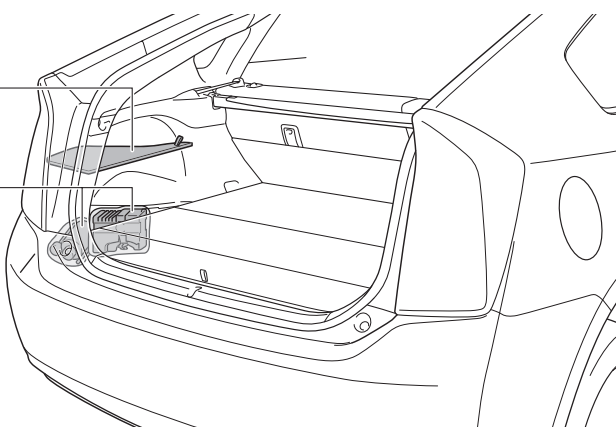

Refer to the *Owner's Manual* for more details.

SAFETY AND EMERGENCY FEATURES

Star Safety System™

All new Toyota vehicles come standard with the Star Safety System™, which combines Vehicle Stability Control (VSC), Traction Control (TRAC), Anti-lock Braking System (ABS), Electronic Brake-force Distribution (EBD), Brake Assist (BA) and Smart Stop Technology (SST).

Enhanced Vehicle Stability Control (VSC)

Enhanced Vehicle Stability Control provides cooperative control of the ABS, TRAC, VSC and EPS.

Enhanced VSC helps to maintain directional stability when loss of traction occurs during a turn.

Traction Control (TRAC)

VSC helps prevent loss of traction during cornering by reducing Hybrid System output, and Traction Control helps maintain traction on loose gravel and wet, icy, or uneven surfaces by applying brake force to the spinning wheel(s).

Toyota's TRAC sensors are activated when one of the drive wheels starts to slip. TRAC limits Hybrid System output and applies the brakes to the spinning wheel. This transfers power to the wheels that still have traction to help keep you on track.

Anti-Lock Brake System (ABS)

ABS helps prevent brakes from locking up by "pulsing" brake pressure to each wheel. This limits brake lockup and helps provide directional control for the current road conditions.

Toyota's ABS sensors detect which wheels are locking up and limits wheel lockup by "pulsing" each wheel's brakes independently. Pulsing releases brake pressure repeatedly for fractions of a second. This helps the tires attain the traction that current road conditions will allow, helping you to stay in directional control.

Electronic Brake Force Distribution (EBD)

Toyota's ABS technology has Electronic Brake-force Distribution (EBD) to help maintain control and balance when braking. Abrupt stops can cause a vehicle to tilt forward, reducing the braking power of the rear wheels. EBD responds to sudden stops by redistributing brake force to enhance the braking effectiveness of all four wheels.

Brake Assist (BA)

Brake Assist is designed to detect sudden or "panic" braking, and then add braking pressure to help decrease the vehicle's stopping distance. When there's only a split second to react, Brake Assist can add additional brake pressure more quickly than just the driver alone can.

Smart Stop Technology (SST)

Smart Stop Technology automatically reduces driving torque when the accelerator and brake pedals are pressed simultaneously under certain conditions.

Floor mat installation

There are two types of Toyota floor mats: carpeted and all-weather. Each vehicle has model-specific floor mats. Installation is easy.

To keep your floor mat properly positioned, follow these steps:

- Only use floor mats designed for your specific model.
- Use only one floor mat at a time, using the retaining hooks to keep the mat in place.
- Install floor mats right side up.

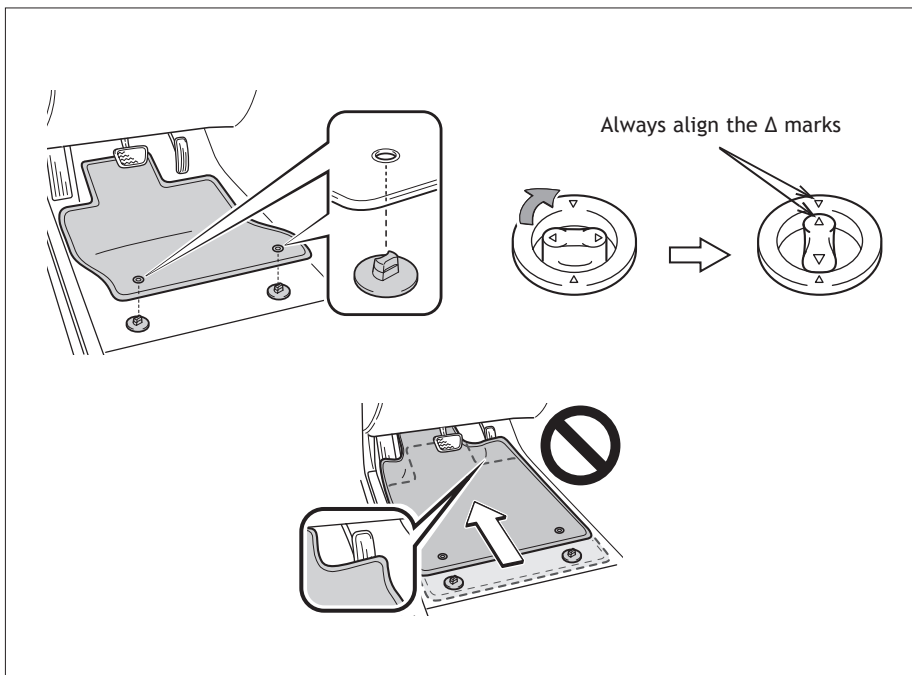



TOYOTA Owners

toyota.com/owners

CUSTOMER EXPERIENCE CENTER

1-800-331-4331

