

COMPONENTS

ILLUSTRATION

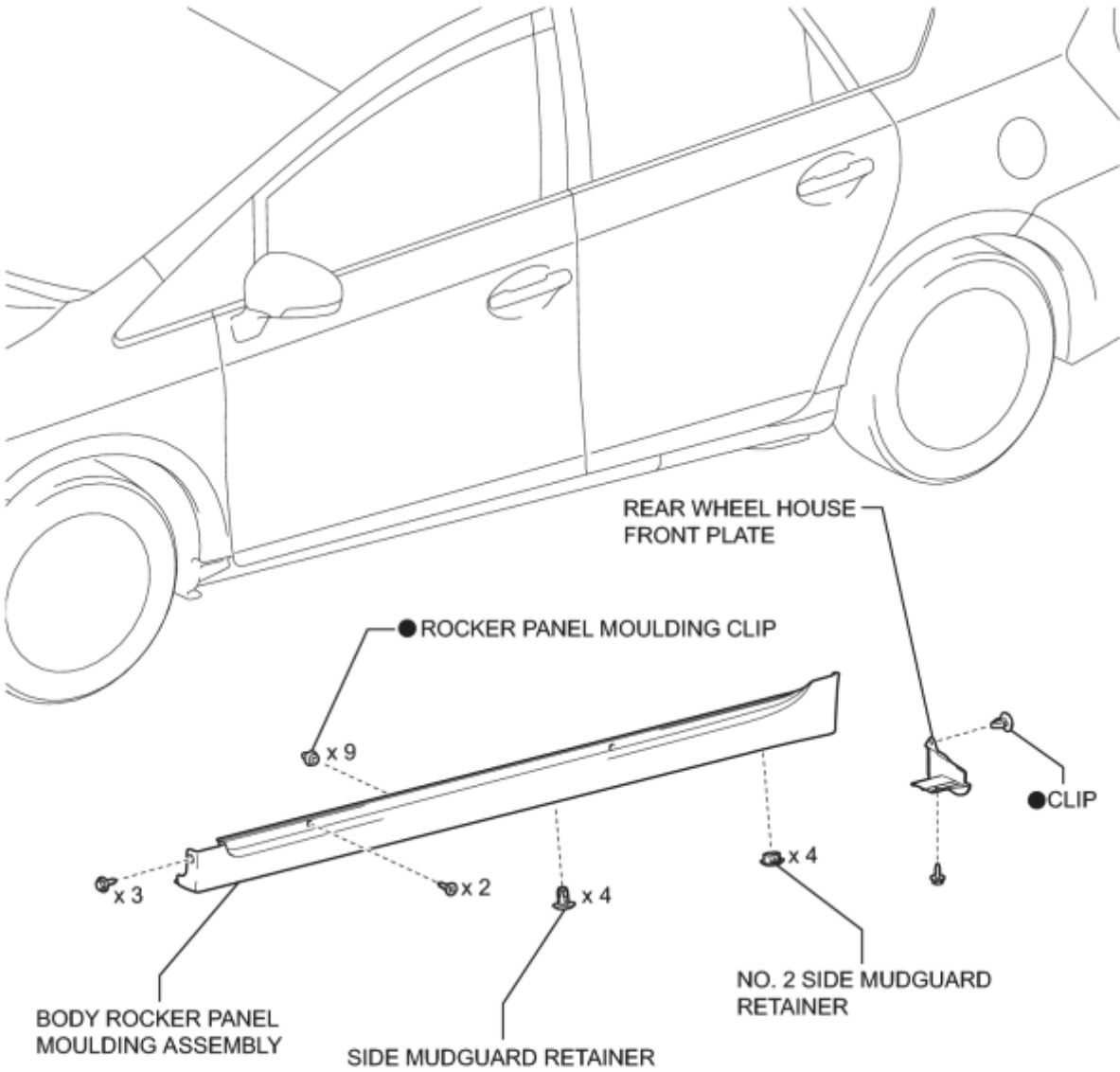

● Non-reusable part

REMOVAL

1. REMOVE REAR WHEEL HOUSE FRONT PLATE_

INFO

2. REMOVE BODY ROCKER PANEL MOULDING ASSEMBLY

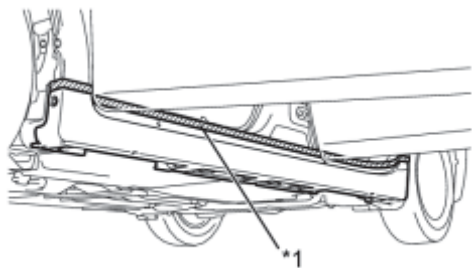

(a) Put protective tape around the body rocker panel moulding assembly.

Text in Illustration

*1	Protective Tape
----	-----------------

P

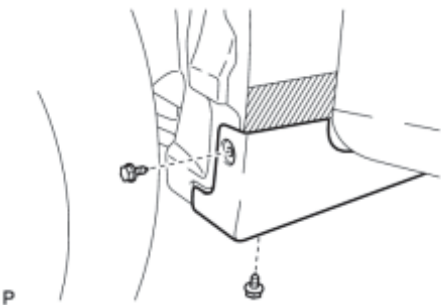

(b) Remove the 2 screws.

P

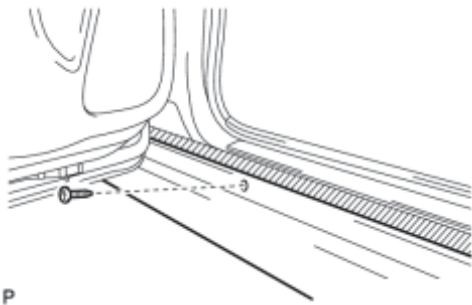

(c) Remove the screw.

P

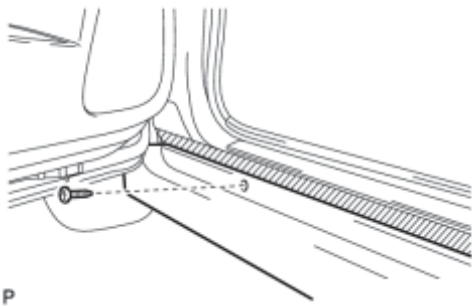

(d) Remove the screw.

P

(e) Remove the screw.

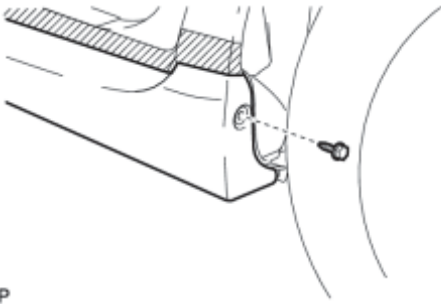

P

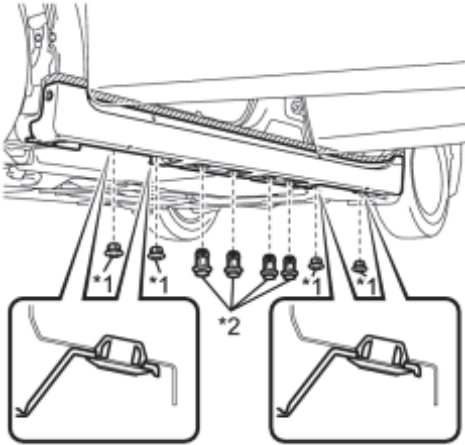

P

(f) Remove the 4 side mudguard retainers and 4 No. 2 side mudguard retainers.

Text in Illustration

*1	No. 2 Side Mudguard Retainer
*2	Side Mudguard Retainer

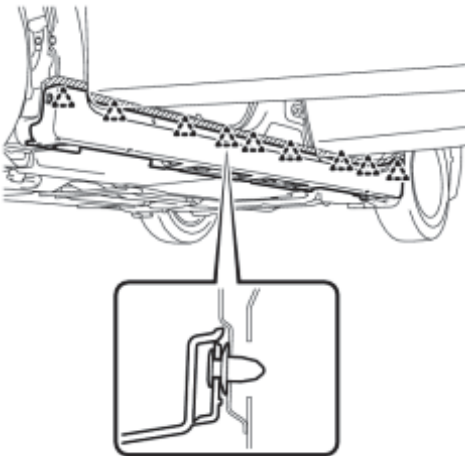

P

(g) Disengage the 9 clips to remove the body rocker panel moulding assembly.

(h) Remove the 9 clips (rocker panel moulding clip).

INSTALLATION

1. INSTALL BODY ROCKER PANEL MOULDING ASSEMBLY

(a) Install 9 new clips (rocker panel moulding clip) to the body rocker panel moulding assembly.

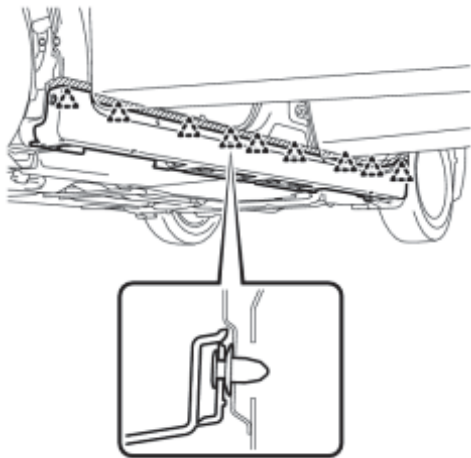

(b) Engage the 9 clips to install the body rocker panel moulding assembly.

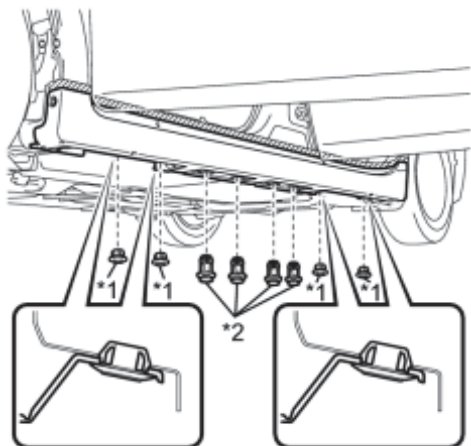

(c) Install the 4 No. 2 side mudguard retainers and 4 side mudguard retainers.

Text in Illustration

*1	No. 2 Side Mudguard Retainer
*2	Side Mudguard Retainer

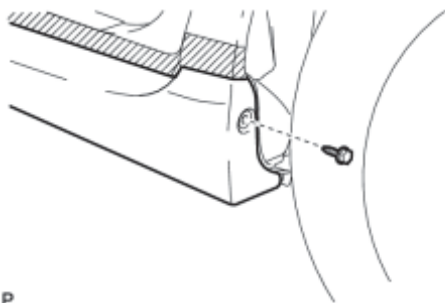

(d) Install the screw.

(e) Install the screw.

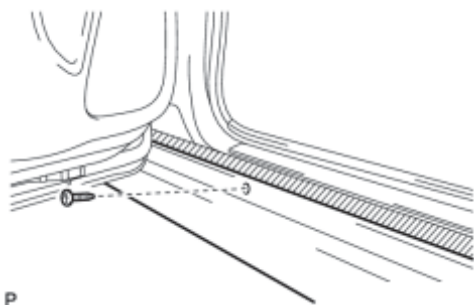

P

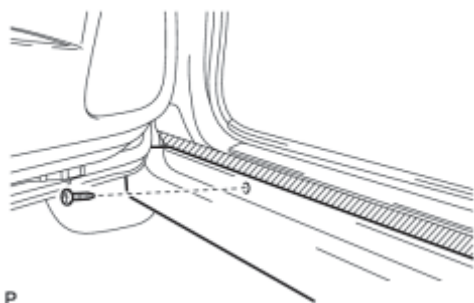

P

(f) Install the screw.

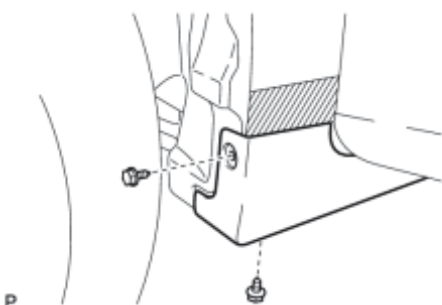

P

(g) Install the 2 screws.

2. INSTALL REAR WHEEL HOUSE FRONT PLATE_ INFO