

# COOLANT HEAT STORAGE WATER PUMP

## COMPONENTS

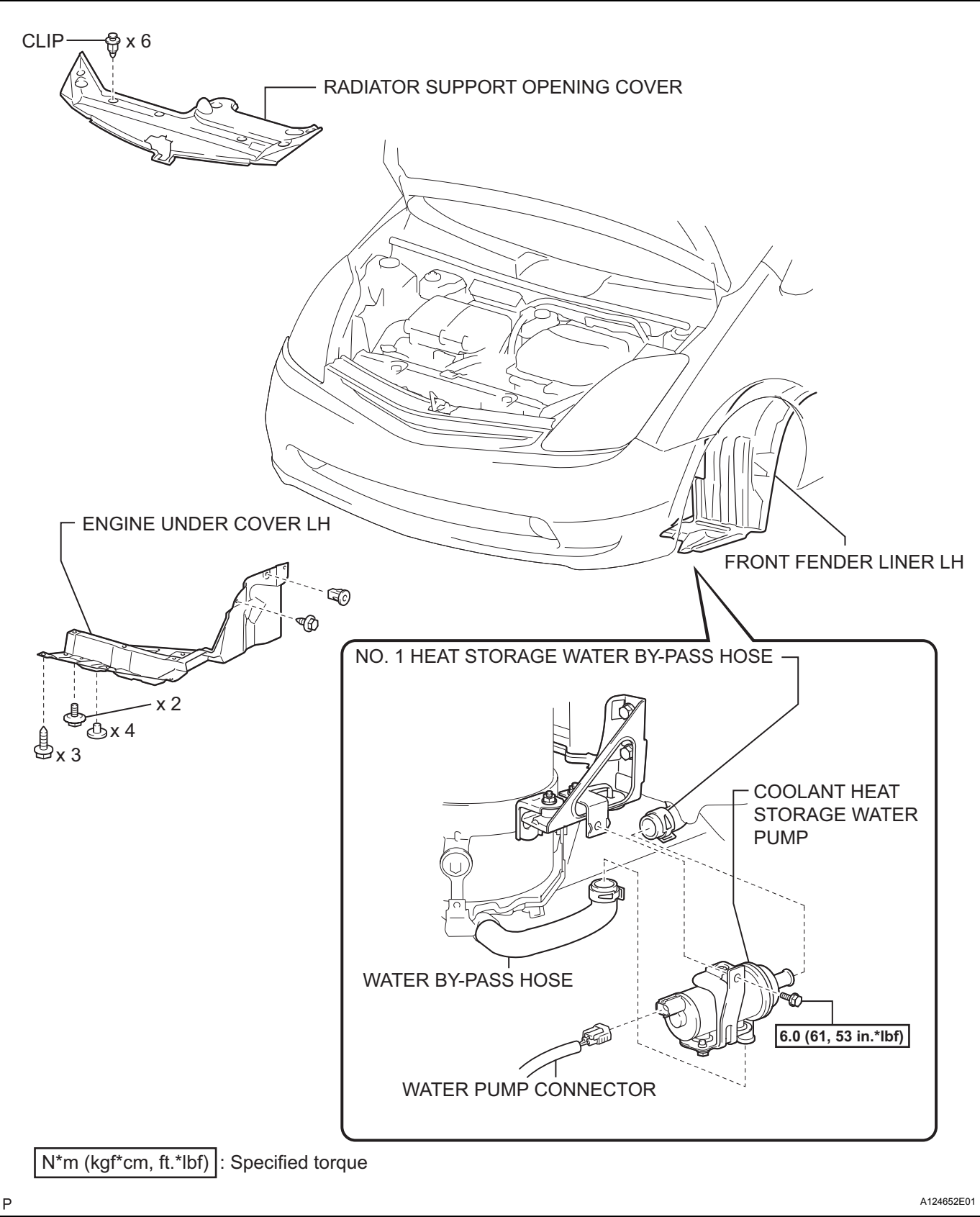

## REMOVAL

1. REMOVE REAR FLOOR NO. 2 BOARD (See page [CH-4](#))
2. REMOVE REAR DECK FLOOR BOX (See page [CH-4](#))
3. REMOVE REAR FLOOR NO. 3 BOARD (See page [CH-4](#))
4. DISCONNECT CABLE FROM BATTERY NEGATIVE TERMINAL  
**CAUTION:**  
Wait at least 90 seconds after disconnecting the cable from the negative (-) battery terminal to prevent airbag and seat belt pretensioner activation.
5. REMOVE RADIATOR SUPPORT OPENING COVER (See page [CO-6](#))
6. REMOVE FRONT WHEEL LH
7. REMOVE ENGINE UNDER COVER LH
8. REMOVE FRONT FENDER LINER LH  
(a) Partially remove the front fender liner LH.
9. DRAIN ENGINE COOLANT (See page [HX-58](#))
10. REMOVE COOLANT HEAT STORAGE WATER PUMP  
(a) Disconnect the coolant heat storage water pump connector.  
(b) Disconnect the 2 hoses.

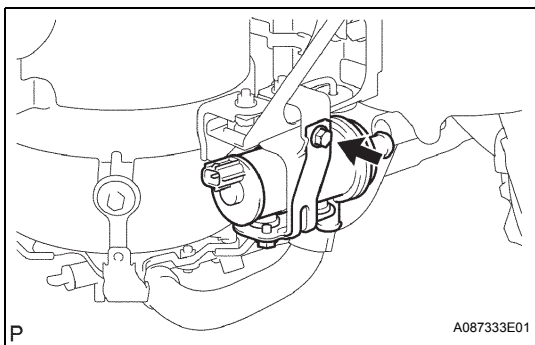
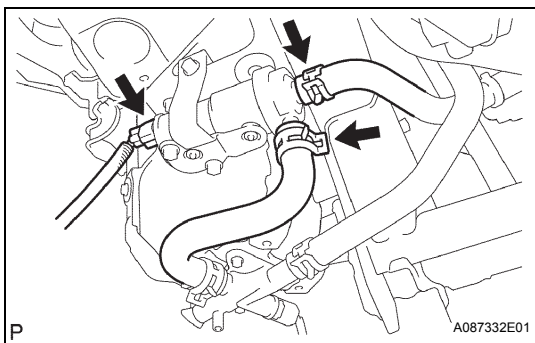

- (c) Remove the bolt and coolant heat storage water pump.

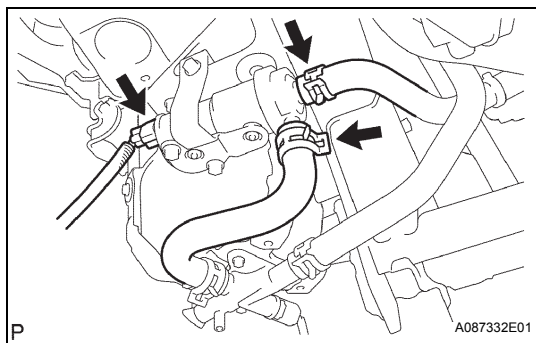
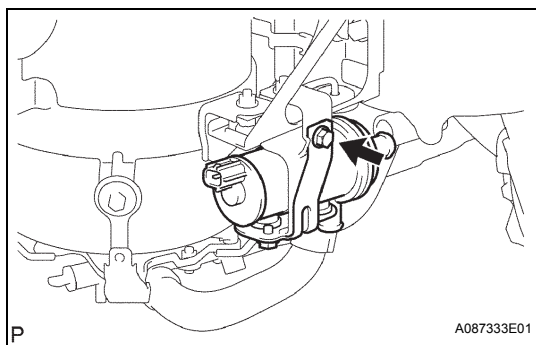

## INSTALLATION

### 1. INSTALL COOLANT HEAT STORAGE WATER PUMP

- (a) Install the coolant heat storage pump water pump with the bolt.

**Torque: 6.0 N\*m (61 kgf\*cm, 53 in.\*lbf)**

- (b) Connect the 2 hoses.

- (c) Connect the connector to the coolant heat storage pump.

### 2. CONNECT CABLE TO BATTERY NEGATIVE TERMINAL

### 3. INSTALL REAR FLOOR NO. 3 BOARD (See page [CH-8](#))

### 4. INSTALL REAR DECK FLOOR BOX (See page [CH-8](#))

### 5. INSTALL REAR FLOOR NO. 2 BOARD (See page [CH-8](#))

### 6. ADD ENGINE COOLANT (See page [HX-58](#))

### 7. INSPECT FOR COOLANT LEAK

### 8. INSTALL FRONT FENDER LINER LH

### 9. INSTALL ENGINE UNDER COVER LH

### 10. INSTALL FRONT WHEEL LH Torque: 103 N\*m (1050 kgf\*cm, 76 ft.\*lbf)

### 11. INSTALL RADIATOR SUPPORT OPENING COVER (See page [CO-9](#))

### 12. PERFORM INITIALIZATION

- (a) Perform initialization (see page [IN-34](#)).

#### NOTICE:

Certain systems need to be initialized after disconnecting and reconnecting the cable from the negative (-) battery terminal.