

—Front turn signal lights

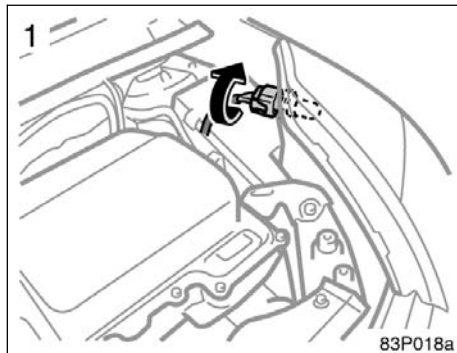

TURN SOCKET COUNTERCLOCKWISE TO REMOVE.
USE A CLEAN SOFT CLOTH TO PULL LAMP OUT.

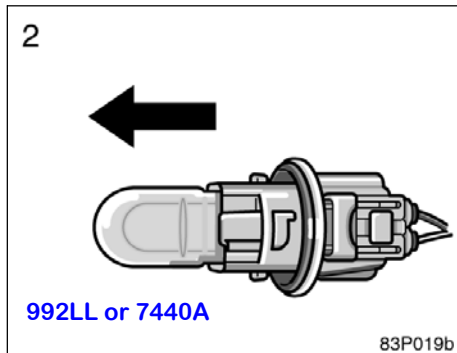

—Rear turn signal, tail and back-up lights

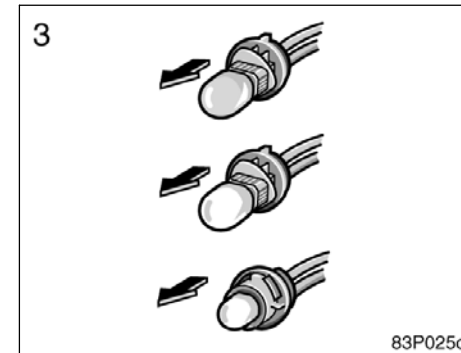
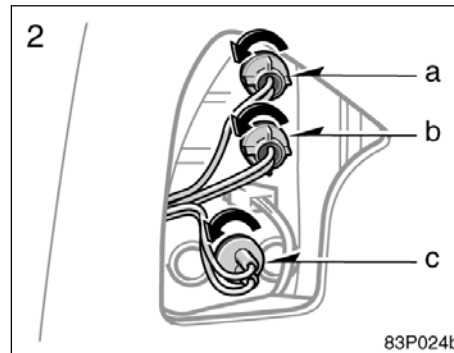
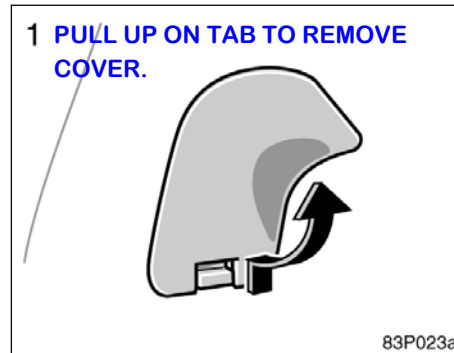

a: Rear turn signal light lamp- 992 (7440A)

b: Back-up light lamp - 7440

c: Tail light lamp - 2825

LAMP PART NUMBERS

| | |
|--------------------------|-------------------|
| High & low beam headlamp | HID-D4R |
| Parking light | 2825 |
| Front turn signal | 992 (7440A) |
| Rear turn signal | 992 (7440A) |
| Tail light | 2825 |
| Stop light | LED-Lens Assembly |
| High mount stop light | LED |
| Fog/Driving light | 9006 |
| License plate | 168 |
| Back up light | 7440 |
| Front sidemarker | 2825 |
| Map light | 168 |
| Dome light | DE3175 |
| Step/Courtesy light | 168 |
| Trunk/Cargo area | DE3022 |