

**Part Number: 08586-47841****Kit Contents**

Item #	Quantity Req'd.	Description
1	1	V2 ECU
2	1	Wire Harness
3	1	ECU Mounting Bracket

**Hardware Bag Contents**

Item #	Quantity Req'd.	Description
1	1	Microphone
2	2	Bolt
3	4	Small Foam Tapes
4	5	Wire Ties
5	2	Window stickers (not used – for use with V5 only)
6	1	Owner's Manual
7	1	Warranty Card

**Additional Items Required For Installation**

Item #	Quantity Req'd.	Description

**Conflicts**

Note:
-------

**Recommended Tools**

<b>Personal &amp; Vehicle Protection</b>	<b>Notes</b>
Safety Glasses	
Safety Gloves	
Vehicle Protection	Blankets, Part Boxes
<b>Special Tools</b>	<b>Notes</b>
Striker Tool (PPO Only)	ALL 02-016-01
Scan Tool and Software Card	01001271 with version 13.1 software (or later)
<b>Installation Tools</b>	<b>Notes</b>
Phillips Head Screwdriver	#2, screwdriver or tip
Screwdriver	Flat Blade, Jeweler's
Sockets	10mm, 12mm
Wrench	10mm
Nylon Panel Removal Tool	e.g. Panel Pry Tool #1 Toyota SST # 00002-06001-01
Pneumatic/Electric Wrench	
Side Cutters	
Torque Wrench	6.0 N·m (53 lbf·in)
<b>Special Chemicals</b>	<b>Notes</b>
Cleaner	3M™ Prep Solvent -70

**NOTE:** Part number of this accessory may not be the same as the part number shown.

**General Applicability**

Note: Prius with factory TDS system only.

**Recommended Sequence of Application**

Item #	Accessory	

\*Mandatory

**Vehicle Service Parts** (may be required for reassembly)

Item #	Quantity Req'd.	Description

**Legend**

**STOP:** Damage to the vehicle may occur. Do not proceed until process has been complied with.



**OPERATOR SAFETY:** Use caution to avoid risk of injury.



**CAUTION:** A process that must be carefully observed in order to reduce the risk of damage to the accessory/vehicle and to ensure a quality installation.



**TOOLS & EQUIPMENT:** Used in Figures calls out the specific tools and equipment recommended for this process.

Care must be taken when installing this accessory to ensure damage does not occur to the vehicle. The installation of this accessory should follow approved guidelines to ensure a quality installation.

These guidelines can be found in the "Accessory Installation Practices" document.

This document covers such items as:-

- Vehicle Protection (use of covers and blankets, cleaning chemicals, etc.).
- Safety (eye protection, rechecking torque procedure, etc.).
- Vehicle Disassembly/Reassembly (panel removal, part storage, etc.).
- Electrical Component Disassembly/Reassembly (battery disconnection, connector removal, etc.).

Please see your Toyota dealer for a copy of this document

## 1. Vehicle Disassembly.

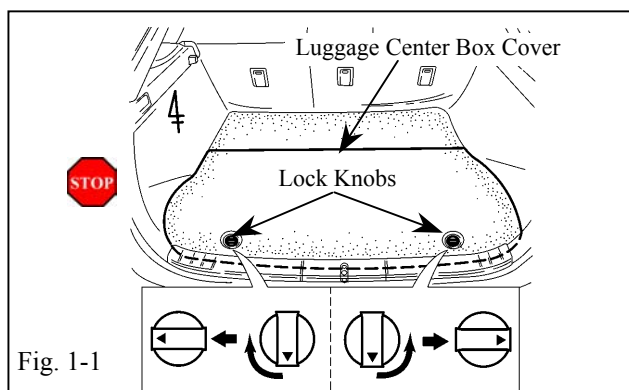

(a) Lift up the luggage center box cover (rear floor board no. 2). (Fig. 1-1)

(1) Cover the rear trunk edge and bumper with blanket before starting.

(2) Release the lock mechanism from the lock to the unlock position.

(b) Lift up the center luggage box (deck floor box rear). (Fig. 1-2)

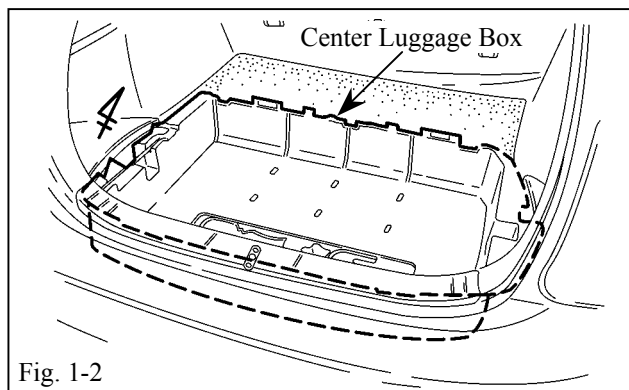

(c) Remove the right (passenger) side battery cover (rear floor board no. 3) including the vertical trim cover by separating the four (4) claw fittings. (Fig. 1-3)

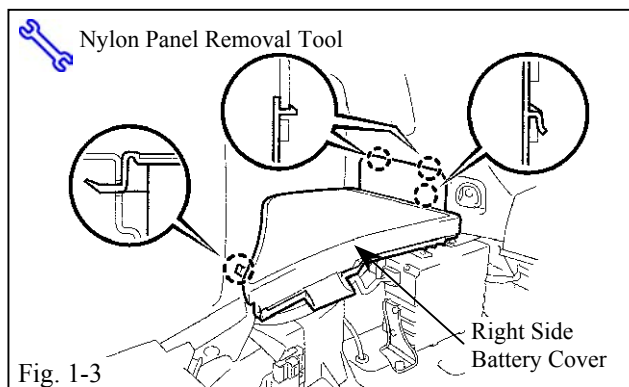

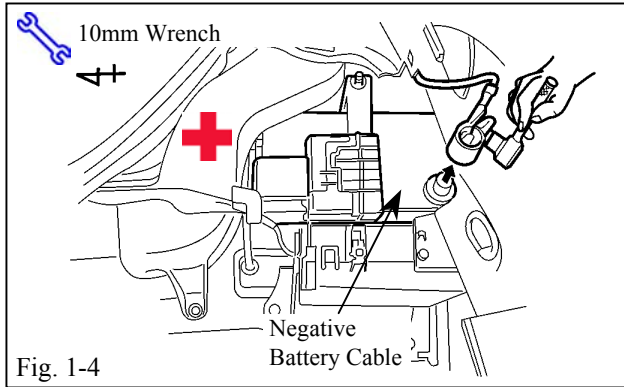

(d) Remove the negative battery cable of the auxiliary battery. (Fig. 1-4)

(1) Do not touch the positive terminal with any tool when removing the cable.

(e) Remove the glove box under cover. (Fig. 1-5)

(f) Remove the center cluster under cover. (Fig. 1-6)

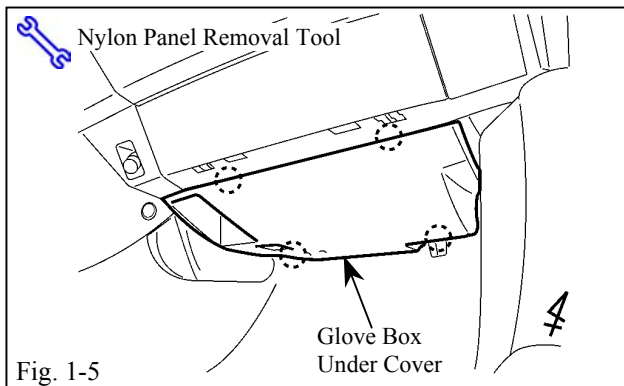

## 2. Microphone Installation.

(a) Using the 3M™ Prep Solvent clean the microphone installation area. (Fig. 2-1)

(1) Always use a clean (lint free scratch resistant) soft cloth (or wipe), and clean a small area at a time (~ 3 ft. x 3 ft. max.).

(2) Shake well.

(3) Apply 3M™ Prep Solvent-70 to cloth or wipe. Do not spray cleaning solution directly on any vehicle surfaces.

(4) Clean surface thoroughly and wipe dry immediately with a new clean cloth. Do not allow cleaner to air dry.

(b) Remove the backing sheet and secure the microphone onto the air duct. (Fig. 2-1)

(1) Do not touch the adhesive surface of the microphone.

(2) Do not cover the opening of the microphone with the foam tape.

(3) Press the microphone to the air duct firmly.

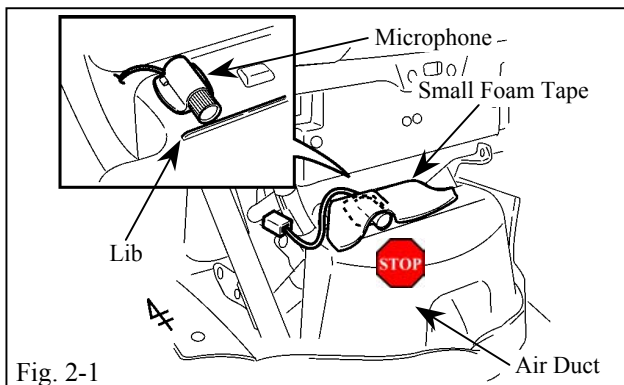
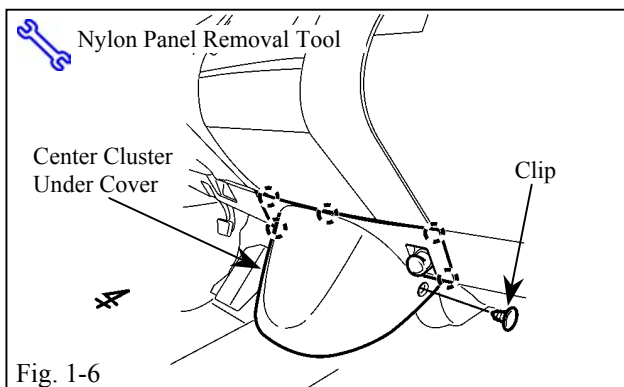

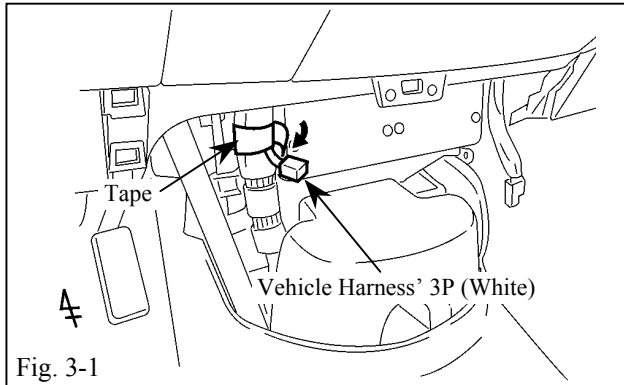

Fig. 3-1

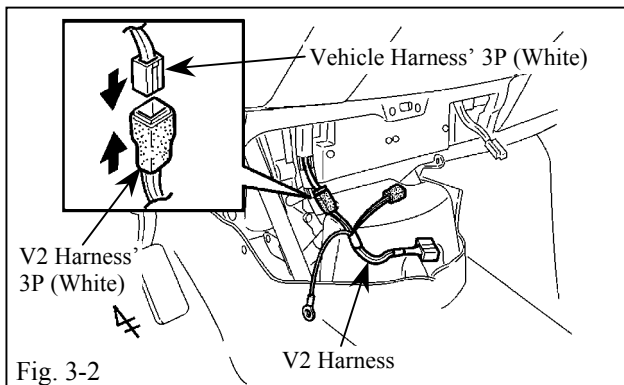

Fig. 3-2

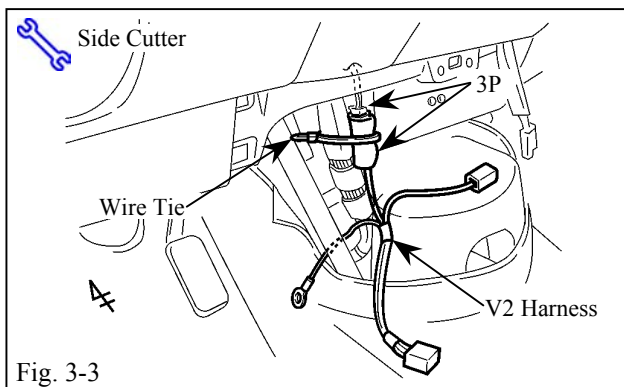

Fig. 3-3

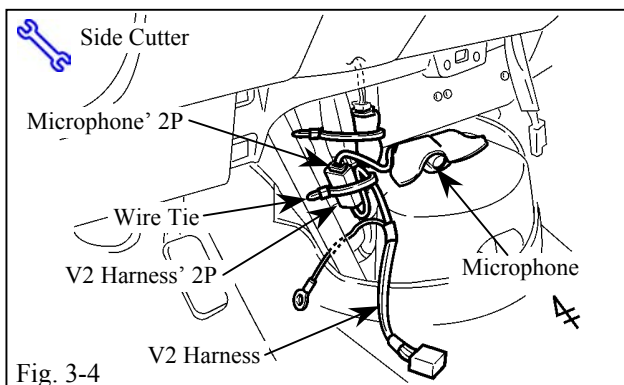
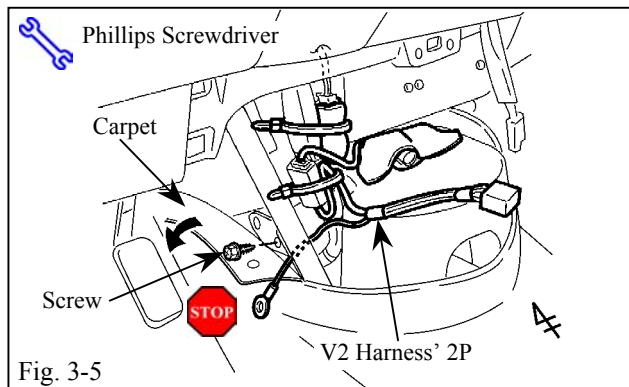

Fig. 3-4

### 3. V2 Harness Installation.

- (a) Locate the vehicle harness' white 3P connector from the driver's side bottom of the center cluster area. Remove the tape from the connector. (Fig. 3-1)
- (b) Plug in the V2 harness' white 3P connector to the vehicle harness' white 3P connector (Fig. 3-2)
  - (1) Verify the connectors are plugged in securely.
- (c) Secure the 3P connector to the vehicle harness with one wire tie. (Fig. 3-3)
- (d) Plug in the V2 harness' white 2P connector to the microphone's white 2P connector. (Fig. 3-4)
  - (1) Verify the connectors are plugged in securely.
- (e) Secure the 2P connector to the vehicle harness with one wire tie. (Fig. 3-4)



- (f) Turn over the carpet in the driver's side as shown, then locate and remove the vehicle's ground screw from the driver side metal brace. (Fig. 3-5)



- (1) Do not discard the screw.

- (g) Secure the V2 harness' ground wire terminal, using the existing screw. (Fig. 3-6)



- (1) Verify the screw is tightened securely.

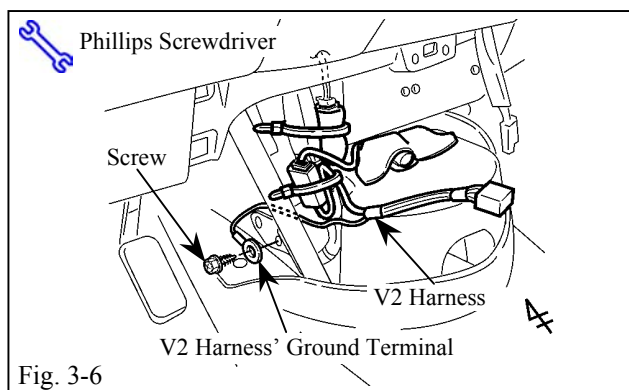

#### 4. V2 ECU Preparation and Installation.

- (a) Turn the adjustment screw on the V2 ECU to the "9" position. (Fig. 4-1)

- (b) Insert the ECU mounting bracket into the indicated bracket slot on the V2 ECU. (Fig. 4-2)



- (1) Insert the mounting bracket into the correct slot; you have only one chance to install it properly.

- (2) Ensure the bracket is firmly attached to the ECU.

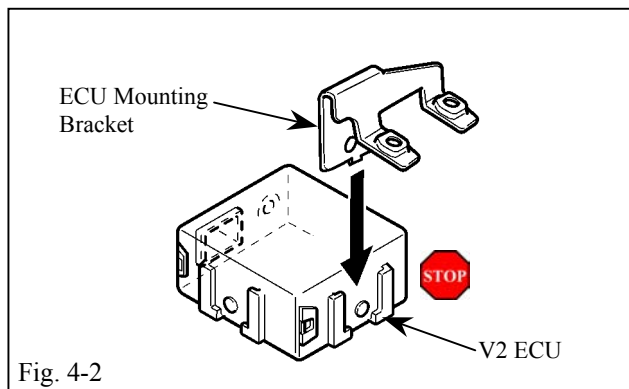
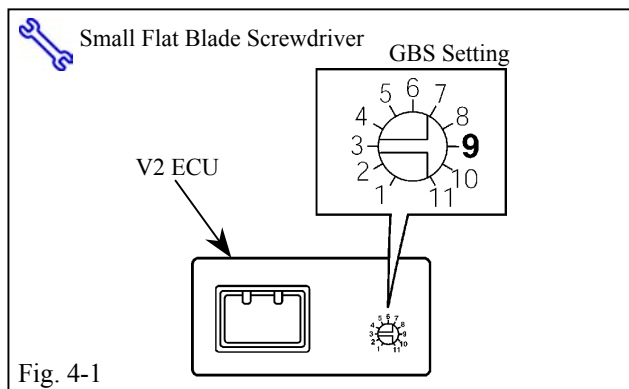

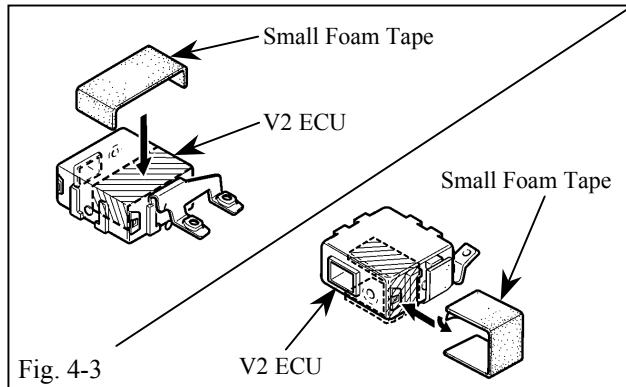

(c) Apply two small foam tapes to the V2 ECU as shown. (Fig. 4-3)

(d) Attach the small foam tape onto the air duct as shown. (Fig. 4-4)

(1) Do not cover the opening of the microphone with the foam tape.

(e) Plug in the V2 harness white 8P connector to the V2 ECU. (Fig. 4-5)

(1) Verify the connector is plugged in securely.

(f) Using two bolts secure the V2 ECU to the center cluster area as shown. (Fig. 4-5)

(1) Verify the screw and bolt are tightened and secured.

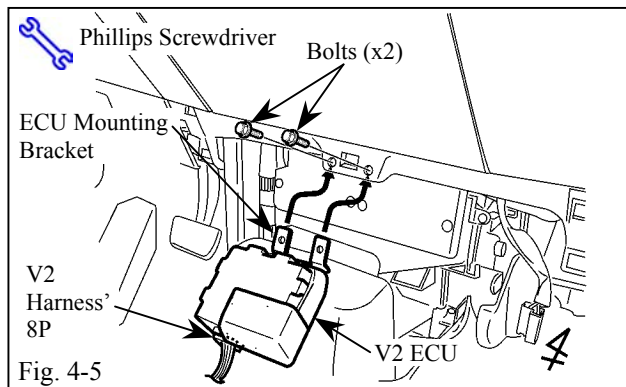
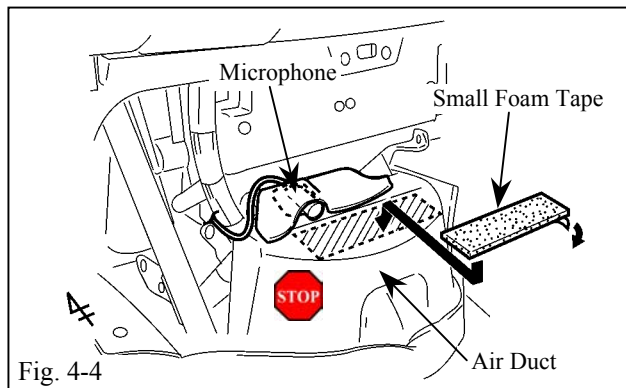

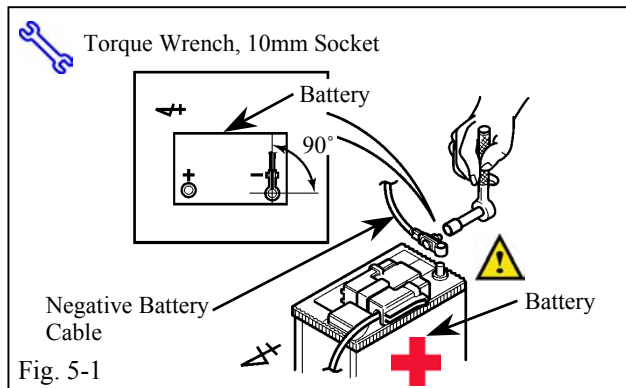

## 5. Completing the Installation.

- (a) Complete the reassembly of the vehicle.
  - (1) Reconnect any disconnected connectors
  - (2) Verify the panels fit together properly with no uneven gaps between them.
- (b) Clean up and remove any trash.
- (c) Reconnect the vehicle's negative battery cable. (Fig. 5-1)
  - (1) Position the negative terminal at an angle of 90° to the battery as shown.
  - (2) Tighten the nut to 6.0 N·m (53 lbf·in).
  - (3) Do not touch the positive terminal with any tool when replacing the cable.
- (d) Reset the power windows.
  - (1) Turn the Start/Stop push button switch to "ON".
  - (2) Press the power window buttons of each door to lower the windows halfway.
  - (3) Press the buttons until the windows close and hold switches up for one (1) additional second.
- (e) Reset the power moon roof.
  - (1) Press and hold the moon roof button until the moon roof is closed. Hold for two (2) additional seconds.
- (f) Place the owner's manual and warranty card, left in their protective bags, in the glove box.

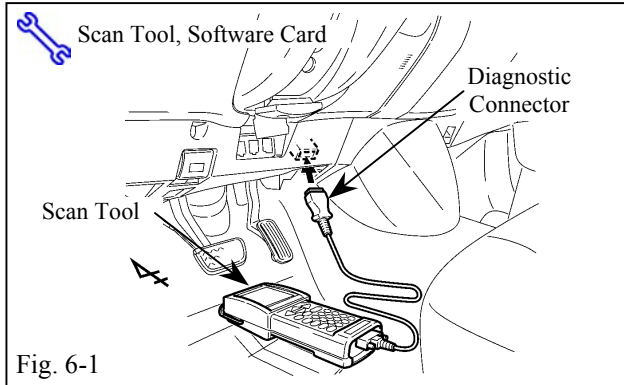

## 6. GBS Setting Procedure.



**NOTE:** Check for the latest version of the software on Toyota Information System (TIS) before setting up the security system.



**NOTE:** Ensure the software is the latest version (Production Version 13.1 (09/16/05) or later.)



**NOTE:** Download the latest software from Toyota Information System (TIS).

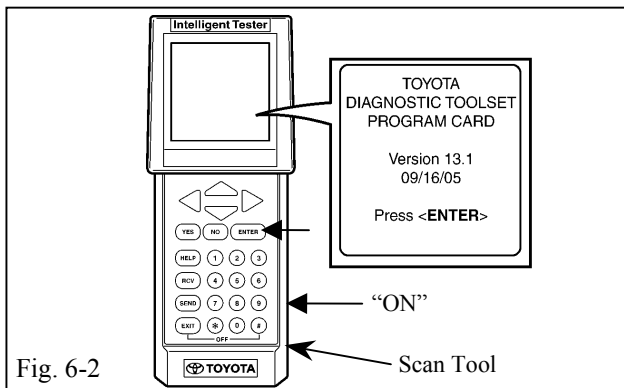

(a) Connect the scan tool connector to the vehicle's diagnostic connector in the lower dash area. (Fig. 6-1)

(b) Insert the remote key or smart key (as appropriate) into the key slot. Press the power button once to select "ACC" position.

(1) Verify the shift position is in "N" position and LED on "P" switch is illuminated.

(c) Push the scan tool main switch "ON" and then press the "ENTER" key. (Fig. 6-2)

### "SELECT VEHICLE" PROCESS

(d) Select the correct vehicle application, "Prius MY2006".

### "ENABLE GLASS BREAKAGE SENSOR" PROCESS

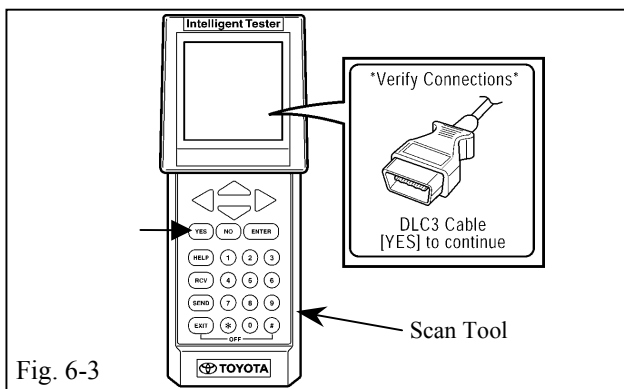

(e) Next, verify the connection of the DLC3 Cable. Press the "YES" button to continue. (Fig. 6-3)

(f) Select "INDIVIDUAL CHANGE" with the scroll key, then press the "ENTER" key. (Fig. 6-4)

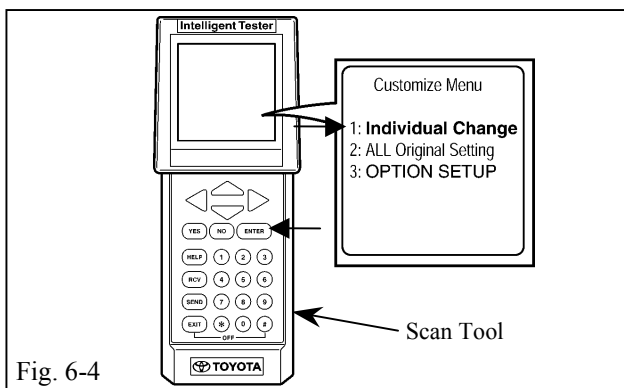



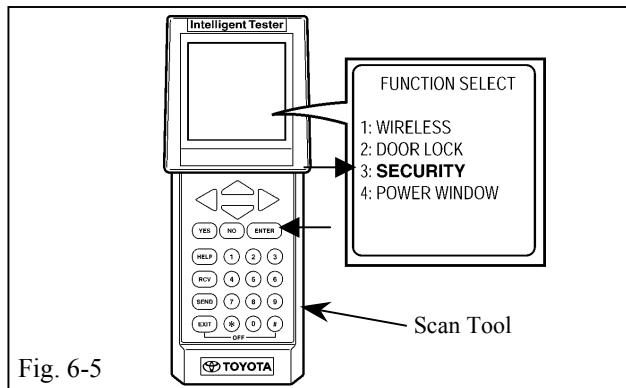

Fig. 6-5

(g) Select "SECURITY" with the scroll key, then press the "ENTER" key. (Fig. 6-5)

(h) Select "WARN BY GLS SEN" with the scroll key, then press the "ENTER" key. (Fig. 6-6)

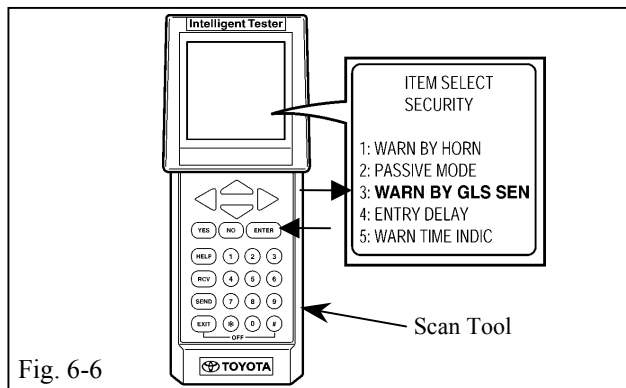

Fig. 6-6

(i) Select "ON" with the scroll key, then press the "ENTER" key. (Fig. 6-7)

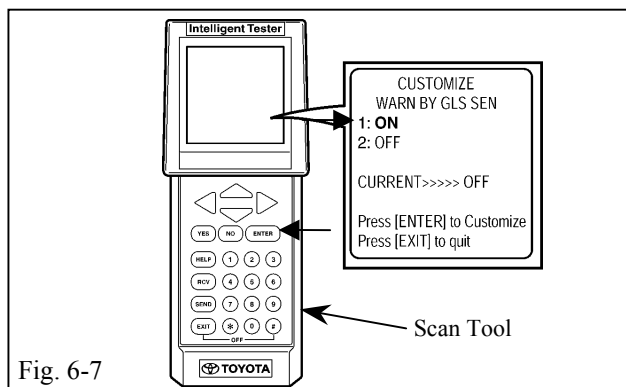

Fig. 6-7

(j) Press the "YES" key. (Fig. 6-8)

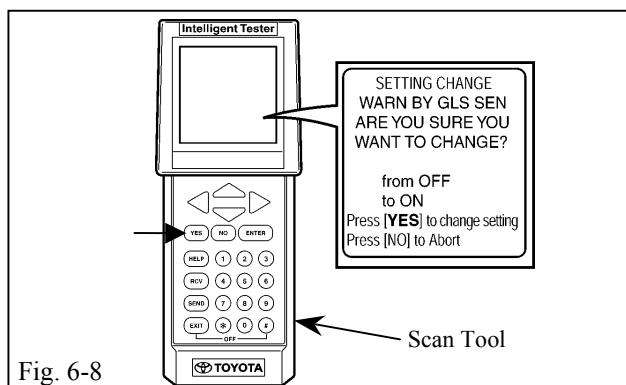
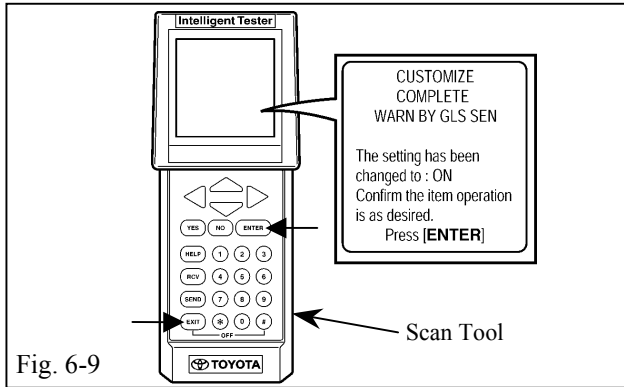



Fig. 6-8



- (k) Press the "ENTER" key. (Fig. 6-9)
- (l) Press and hold the "ON" button, then press the "EXIT" button to turn off the scan tool.
- (1) Disconnect the scan tool from the vehicle's diagnostic connector.

Checklist - these points **MUST** be checked to ensure a quality installation.

Check:	Look For:
<p><u>Accessory Function Checks</u></p> <p><b>Fit the appropriate fuse before beginning.</b></p> <p><b>Close the hood before beginning.</b></p> <p><input type="checkbox"/> Press and release the remote key's lock button to start the system's arming process.</p> <p><input type="checkbox"/> Wait 30 seconds.</p> <p><b>Perform the following checks in a temperature-controlled environment (50°-90°F)</b></p> <p> <input type="checkbox"/> With the tip of a key (or striker tool pulled all the way out [PPO only]), tap the center of the driver's door window to trigger the "warn away" alarm.</p> <p><input type="checkbox"/> Insert the key into the driver's door key cylinder and turn it toward the back of the vehicle to stop the alarm.</p>	<p><u>Look For:</u></p> <ol style="list-style-type: none"> <li>1. The turn signal lights flash once. The buzzer chirps once. All doors lock. The security LED lights up.</li> <li>2. After 30 seconds, the Security LED starts flashing; the system is now armed.</li> <li>3. The horn sounds repeatedly. The interior lights turn on. The headlights flash repeatedly. The turn signal lights flash repeatedly. The security LED lights up.</li> </ol> <p><b>NOTE:</b> Increase the GBS sensitivity setting to the next level if the alarm does not trigger.</p> <p><b>NOTE:</b> If you do not disarm the system, the alarm will last 20 seconds. <i>It is not necessary to check the alarm duration.</i></p> <ol style="list-style-type: none"> <li>4. The horn stops sounding. All the lights stop flashing and/or turn off. The security LED starts to flash.</li> </ol>

**TOYOTA                      PRIUS                      2006 -                      TVIP V2 (GBS ADD ON)**

Checklist - these points **MUST** be checked to ensure a quality installation.

<u>Check:</u>	<u>Look For:</u>
<u>Vehicle Function Checks</u>	
<input type="checkbox"/> Head Lights	Functioning Head Lights
<input type="checkbox"/> High Beams	Functioning High Beams
<input type="checkbox"/> Turn Signal Lights	Functioning Turn Signal Lights
<input type="checkbox"/> Tail Lights	Functioning Tail Lights
<input type="checkbox"/> Stop Lights	Functioning Stop Lights
<input type="checkbox"/> Backup Lights	Functioning Backup Lights
<input type="checkbox"/> Hazard Lights	Functioning Hazard Lights
<input type="checkbox"/> Marker Lights	Functioning Marker Lights
<input type="checkbox"/> Dome/Courtesy Lights	Functioning Dome/Courtesy Lights
<input type="checkbox"/> Panel/Switch Illumination	Functioning Panel/Switch Illumination
<input type="checkbox"/> Accessory Controls/Illumination (if equipped)	Functioning Controls/Illumination
<input type="checkbox"/> Key Sensor Buzzer	Functioning Key Sensor
<input type="checkbox"/> Fog Lights (if equipped)	Functioning Fog Lights
<input type="checkbox"/> Daytime Running Lights (if equipped)	Functioning DR Lights
<input type="checkbox"/> Trunk/Tailgate/Bed Lights (if equipped)	Functioning Lights
<input type="checkbox"/> Glove Box Light (if equipped)	Functioning Glove Box Light
<input type="checkbox"/> Cruise Control Light (if equipped)	Functioning Cruise Control Light
<input type="checkbox"/> Seat Belt Warning Light	Functioning Seatbelt Warning Light. If the warning light remains on, it may indicate a system malfunction.
<input type="checkbox"/> Air Bag Warning Light	Functioning Air Bag Warning Light. If the warning light remains on, it may indicate a system malfunction.

**TOYOTA                      PRIUS                      2006 -                      TVIP V2 (GBS ADD ON)**

Checklist - these points **MUST** be checked to ensure a quality installation.

Check:

- ☐ ABS Light (if equipped)
- ☐ Lamp Failure Sensor (if equipped)
- ☐ Track/Skid Control Light (if equipped)
- ☐ HVAC Controls
- ☐ Power Locks (if equipped)
- ☐ Power Windows (if equipped)
- ☐ Power Seats (if equipped)
- ☐ Power Sunroof (if equipped)
- ☐ Horn
- ☐ Gauges
- ☐ Front Wiper/Washer
- ☐ Rear Wiper/Washer (if equipped)
- ☐ Clock (if equipped)
- ☐ Accessory Power Socket (if equipped)
- ☐ Starter
- ☐ Audio/Video (if equipped)
- ☐ Power Sliding Door (if equipped)
- ☐ Convenience Memory Settings (if equipped)
- ☐ Heated Seats (if equipped)

Look For:

- Functioning ABS Light. If the warning light remains on, it may indicate a system malfunction.
- Functioning Lamp Failure Light. If the warning light remains on, it may indicate a system malfunction.
- Functional Track/VSC Light. If the warning light remains on, it may indicate a system malfunction.
- Functioning HVAC Controls
- Functioning Power Locks
- Functioning Power Windows
- Functioning Power Seats
- Functioning Sunroof
- Functioning Horn
- Functioning Gauges
- Functioning Front Wiper/Washer
- Functioning Rear Wiper/Washer
- Functioning Clock
- Functioning Power Socket
- Functioning Starter
- Functioning Audio/Video
- Functioning Power Sliding Door
- Functioning Memory Settings
- Functioning Heated Seats

**TOYOTA                      PRIUS                      2006 -                      TVIP V2 (GBS ADD ON)**

Checklist - these points **MUST** be checked to ensure a quality installation.

Check:

- ☐ Message Seats (if equipped)
- ☐ Rear Window Defogger (if equipped)
- ☐ Power Side Mirrors (if equipped)
- ☐ Side Mirror Defogger (if equipped)
- ☐ Front Windshield Defogger (if equipped)
- ☐ Navigation System (if equipped)
- ☐ Rear Sunshade (if equipped)

**Remove the appropriate fuse after  
checks are completed.**

Look For:

Functioning Message Seats

Functioning Rear Window Defogger

Functioning Power Side Mirrors

Functioning Side Mirror Defogger

Functioning Front Windshield Defogger

Functioning Navigation System

Functioning Rear Sunshade