

COMPONENTS

ILLUSTRATION

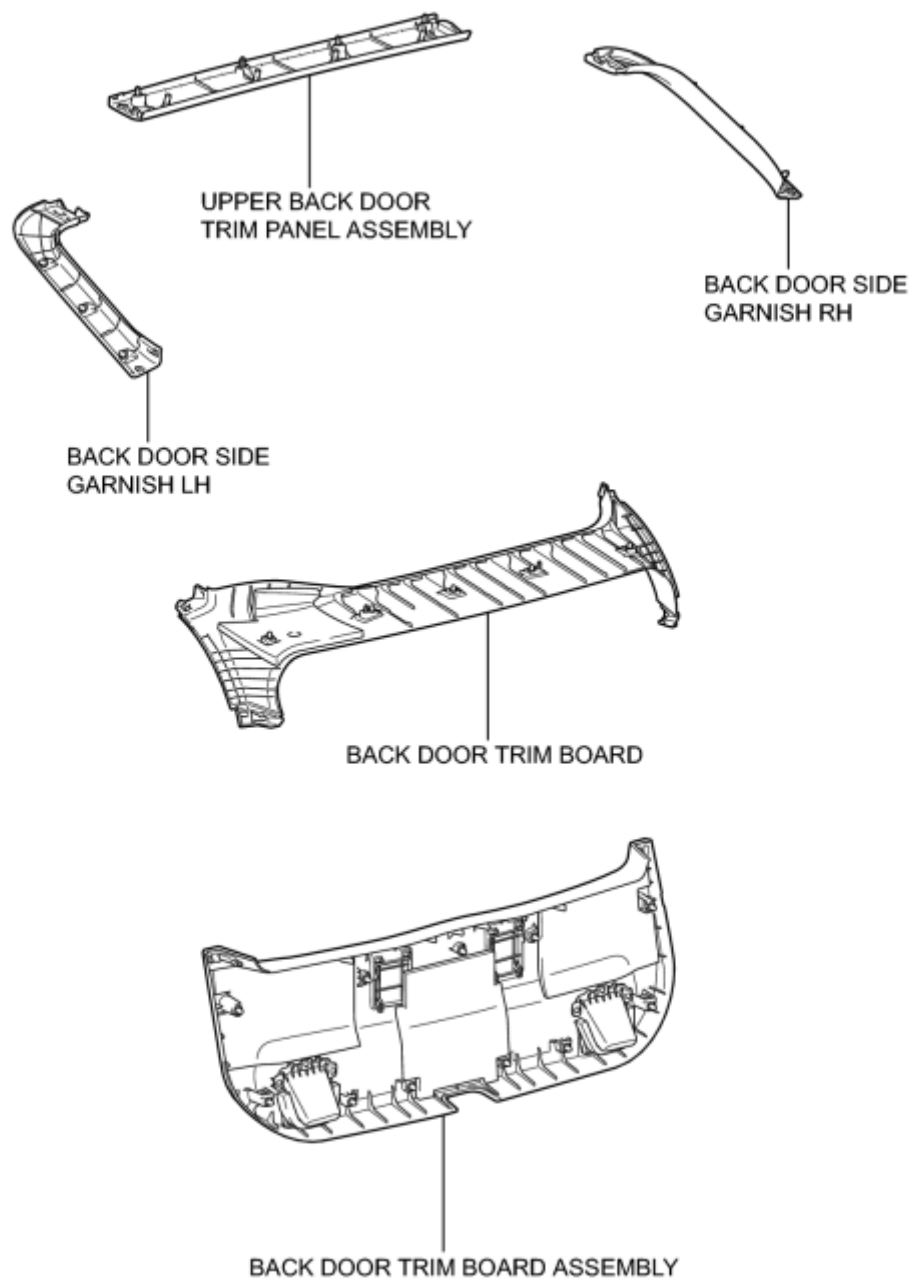

P

ILLUSTRATION

REAR SPOILER ASSEMBLY

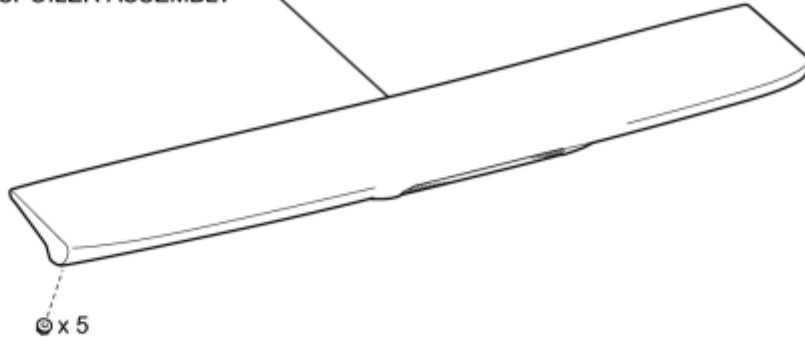

x 5

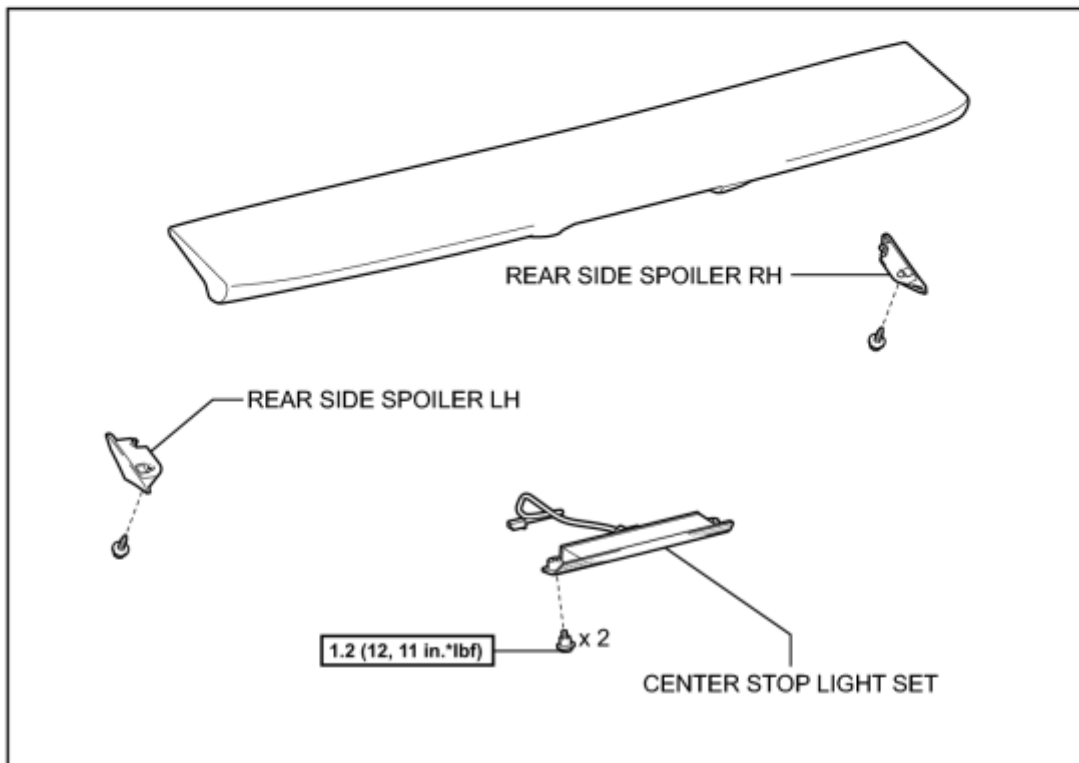

REAR SIDE SPOILER RH

REAR SIDE SPOILER LH

1.2 (12, 11 in.*lbf)

x 2

CENTER STOP LIGHT SET

N*m (kgf*cm, ft.*lbf) : Specified torque

P

REMOVAL

1. REMOVE UPPER BACK DOOR TRIM PANEL ASSEMBLY_ [INFO](#)

2. REMOVE BACK DOOR SIDE GARNISH RH_ [INFO](#)

3. REMOVE BACK DOOR SIDE GARNISH LH_ [INFO](#)

4. REMOVE BACK DOOR TRIM BOARD ASSEMBLY_ [INFO](#)

5. REMOVE BACK DOOR TRIM BOARD_ [INFO](#)

6. REMOVE REAR SPOILER ASSEMBLY

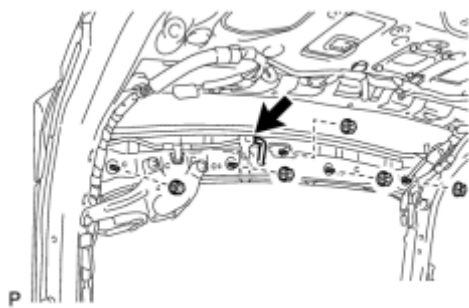

(a) Disconnect the connector.

(b) Remove the 5 nuts.



(c) Disengage the 2 clips to remove the rear spoiler assembly.

7. REMOVE CENTER STOP LIGHT SET_ [INFO](#)

8. REMOVE REAR SIDE SPOILER LH

(a) Remove the screw.



(b) Disengage the guide and remove the rear side spoiler LH.

9. REMOVE REAR SIDE SPOILER RH

HINT:

Use the same procedure for the RH side and LH side.

INSTALLATION

1. INSTALL REAR SIDE SPOILER LH

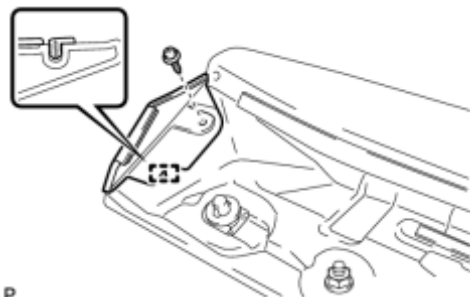

(a) Engage the guide and install the rear side spoiler LH.

(b) Install the screw.

2. INSTALL REAR SIDE SPOILER RH

HINT:

Use the same procedure for the RH side and LH side.

3. INSTALL CENTER STOP LIGHT SET [INFO](#)

4. INSTALL REAR SPOILER ASSEMBLY

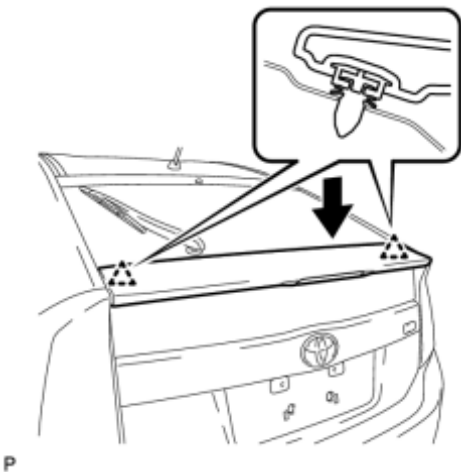

(a) Engage the 2 clips to install the rear spoiler assembly.

(b) Install the 5 nuts.

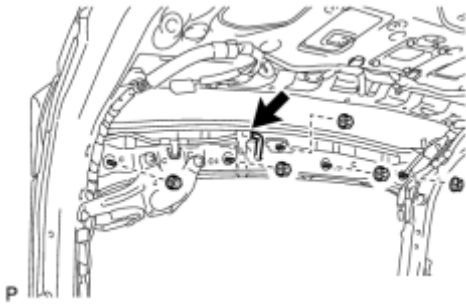

(c) Connect the connector.

5. INSTALL BACK DOOR TRIM BOARD_ [INFO](#)

6. INSTALL BACK DOOR TRIM BOARD ASSEMBLY_ [INFO](#)

7. INSTALL BACK DOOR SIDE GARNISH LH_ [INFO](#)

8. INSTALL BACK DOOR SIDE GARNISH RH_ [INFO](#)

9. INSTALL UPPER BACK DOOR TRIM PANEL ASSEMBLY_ [INFO](#)