

BODY PANEL SEALING AREAS

HINT:

- 1) Prior to applying body sealer, clean the area with a rag soaked in grease, wax and silicone remover.
- 2) If weld-through primer was used, first wipe off any excess and coat with anti-corrosion primer before applying body sealer.
- 3) Wipe off excess body sealer with a rag soaked in a grease, wax and silicone remover.
- 4) If body sealer is damaged by peeling, cracks, etc., be sure to repair as necessary.

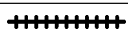

Flat Finishing

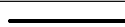

No Flat Finishing

1. ENGINE COMPARTMENT

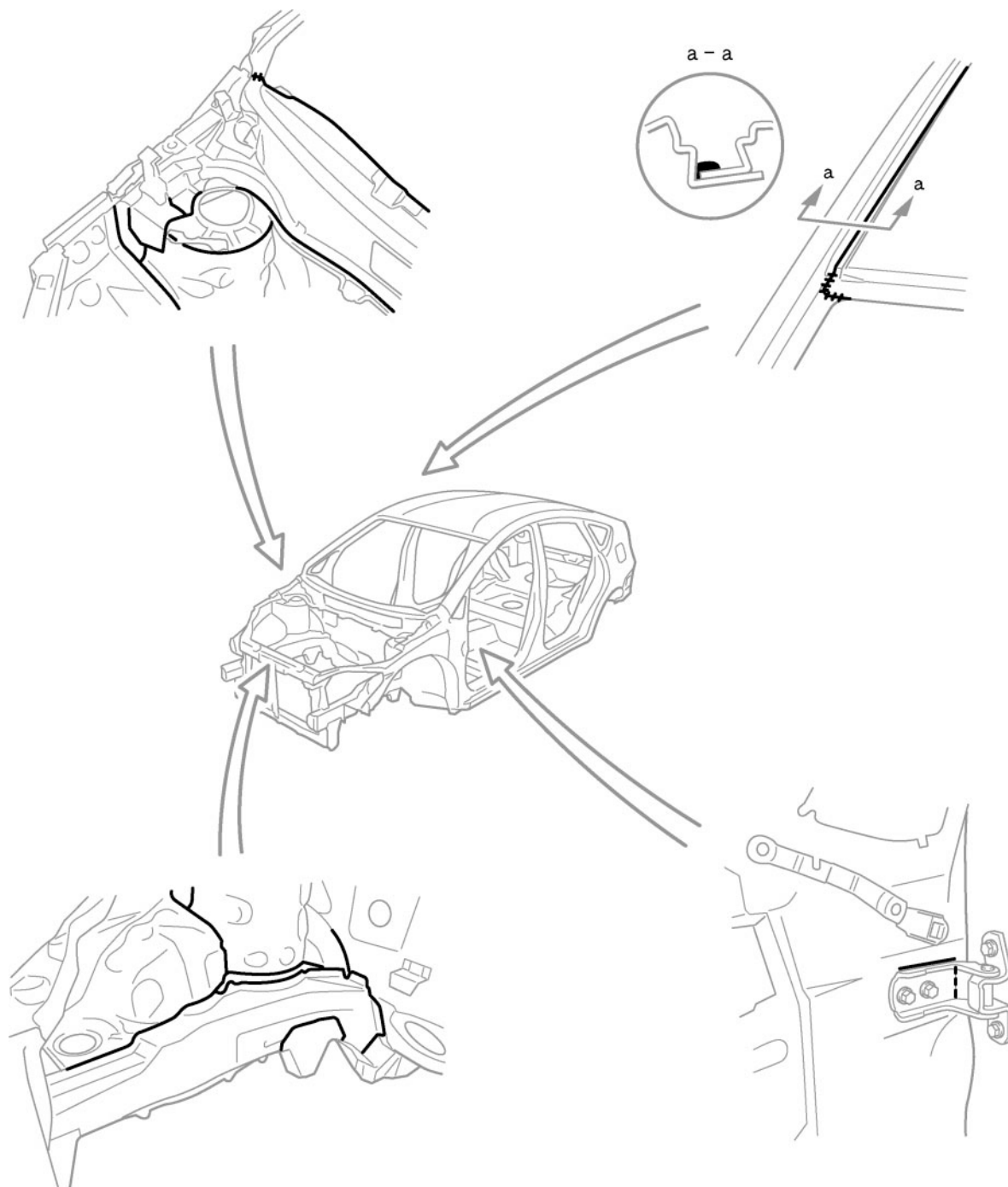

BODY PANEL UNDERCOATING AREAS

HINT:

- 1) First wipe off any dirt, grease or oil with a rag soaked in a grease, wax and silicone remover.
- 2) Cover the surrounding areas with masking paper to avoid coating unnecessary areas. If other areas are accidentally coated, wipe off the coating immediately.
- 3) Apply the first coating of undercoat to all welded areas and panel joints, then apply a second coat over the entire area.
- 4) Do not coat parts which become hot, such as the tailpipe, or moving parts, such as the propeller shaft.
- 5) Besides the locations described below, apply undercoating to all weld points under the body to insure corrosion prevention.
- 6) Be sure to seal the edge of the flange of the member and bracket with undercoating.
- 7) If undercoat is damaged by peeling, cracks, etc., be sure to repair as necessary.
- 8) Before the undercoat apply sealer allowing rust prevention to be attained.

[U.S.A.]

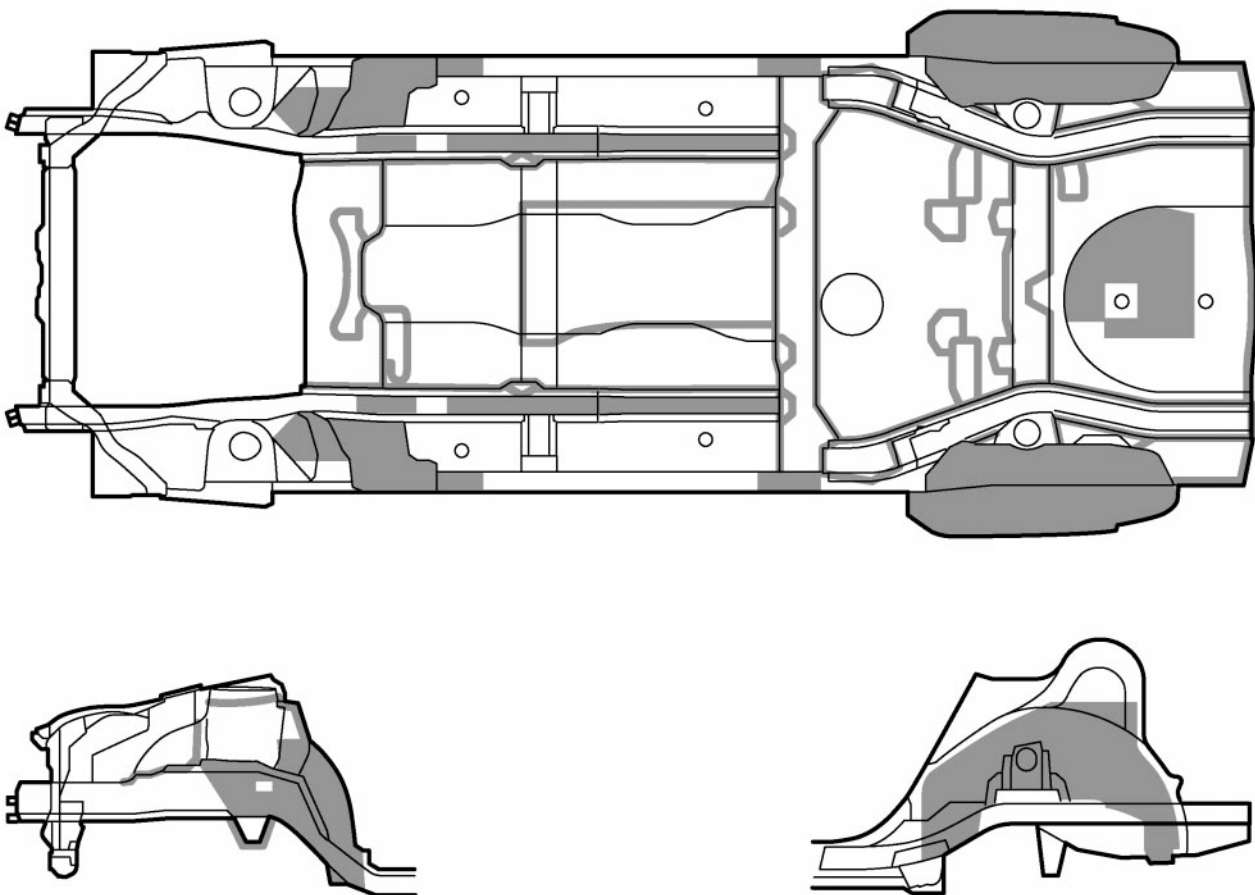

F16106

REFERENCE

Referring to the notes above, undercoating should be applied according to the specifications for your country.

[EURO]

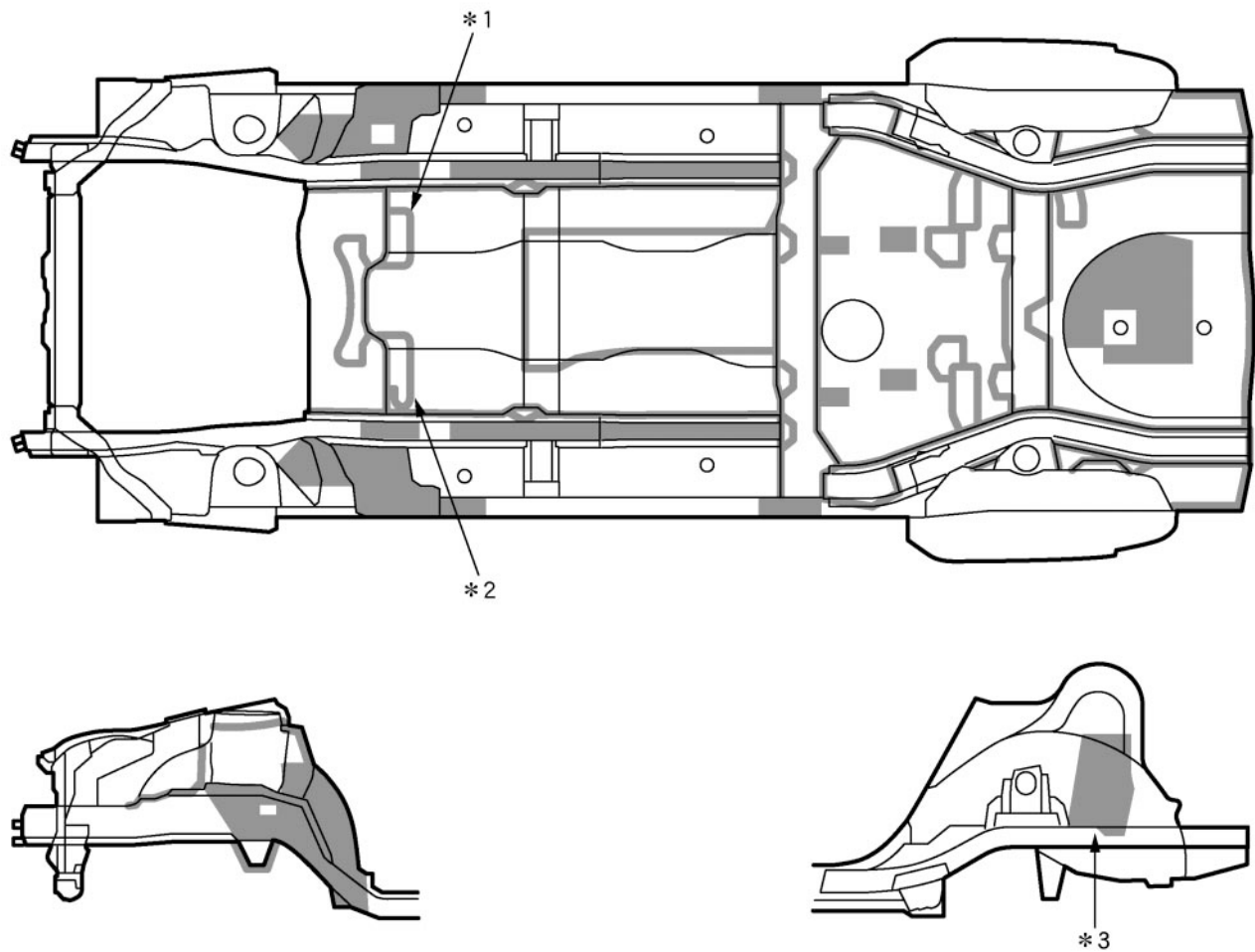

F13558

REFERENCE

Referring to the notes above, undercoating should be applied according to the specifications for your country.

POINT

1 *1 RHD Only *2 LHD Only *3 LH Only

[Ex. U.S.A,EURO]

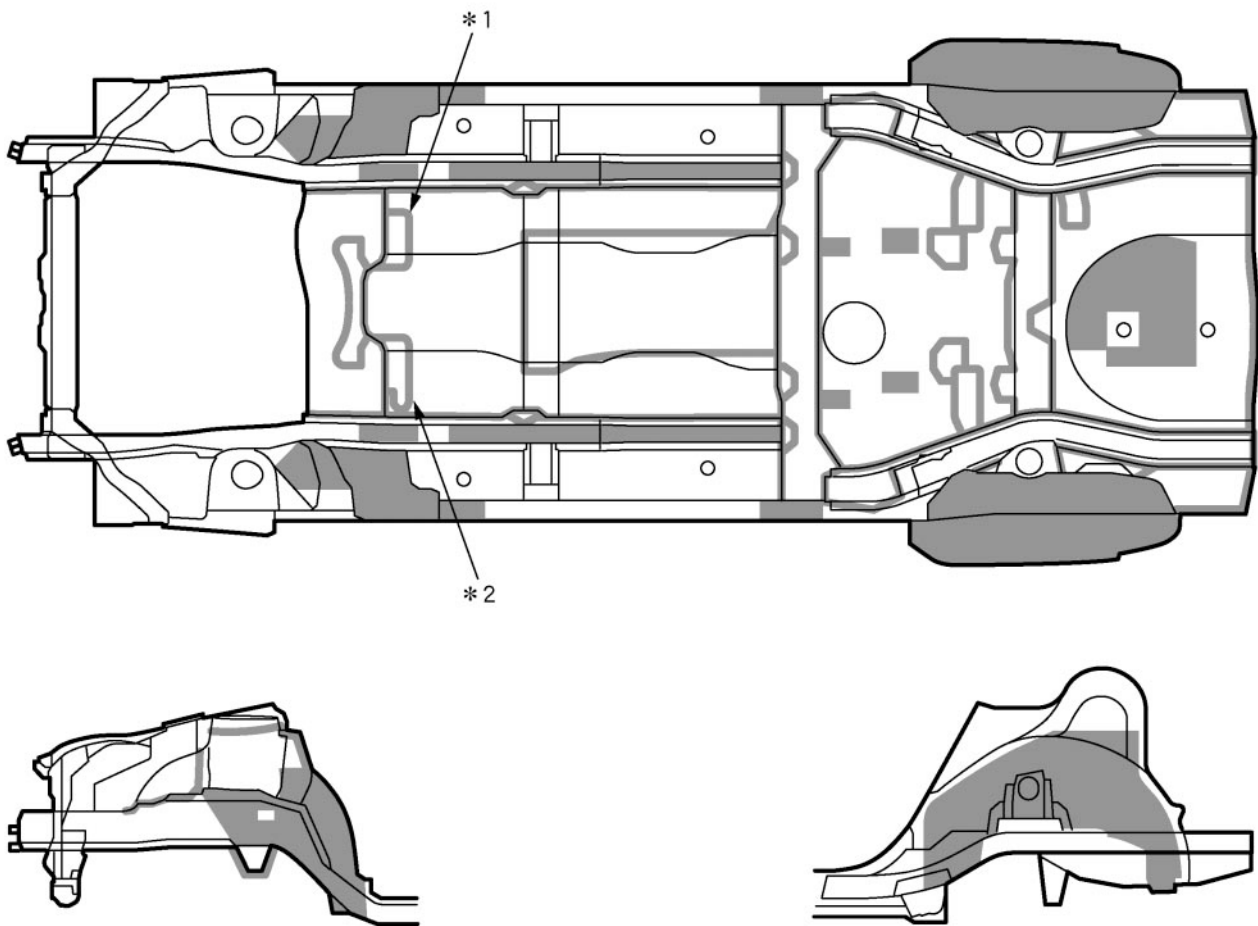

F13559

REFERENCE

Referring to the notes above, undercoating should be applied according to the specifications for your country.

POINT

1 *1 RHD Only *2 LHD Only

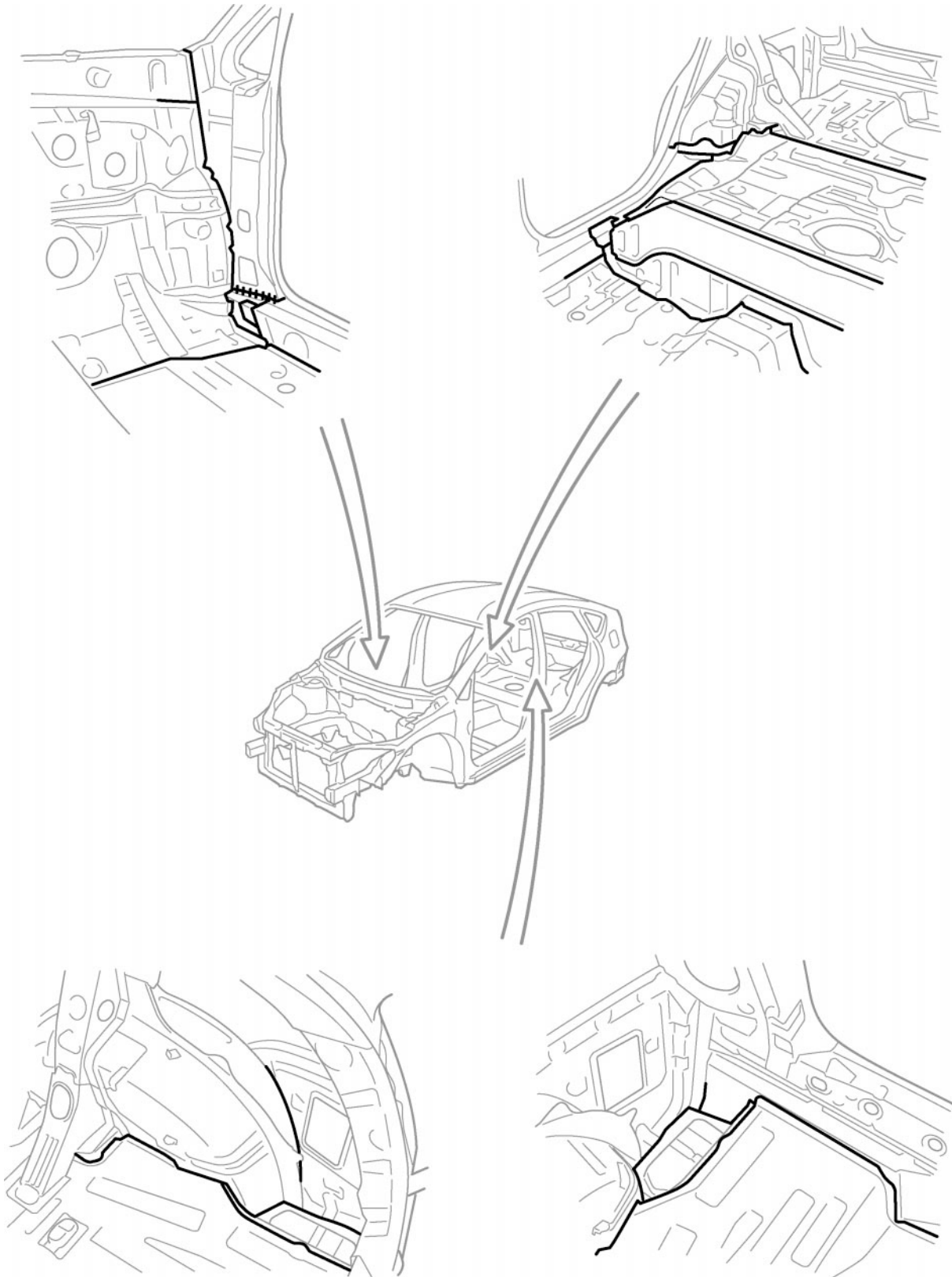
2. INSIDE

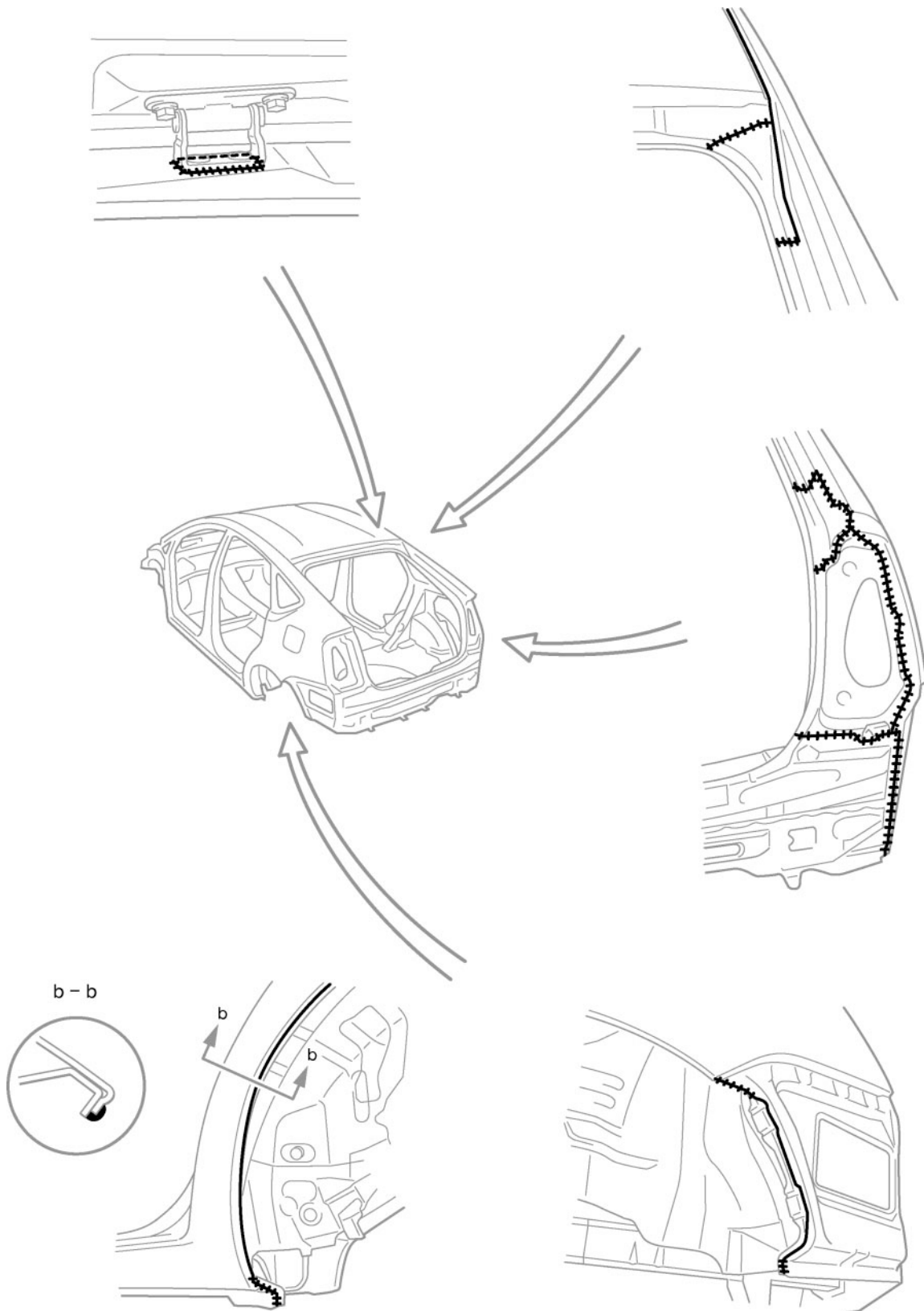
3. REAR LUGGAGE COMPARTMENT

4. DOOR PARTS

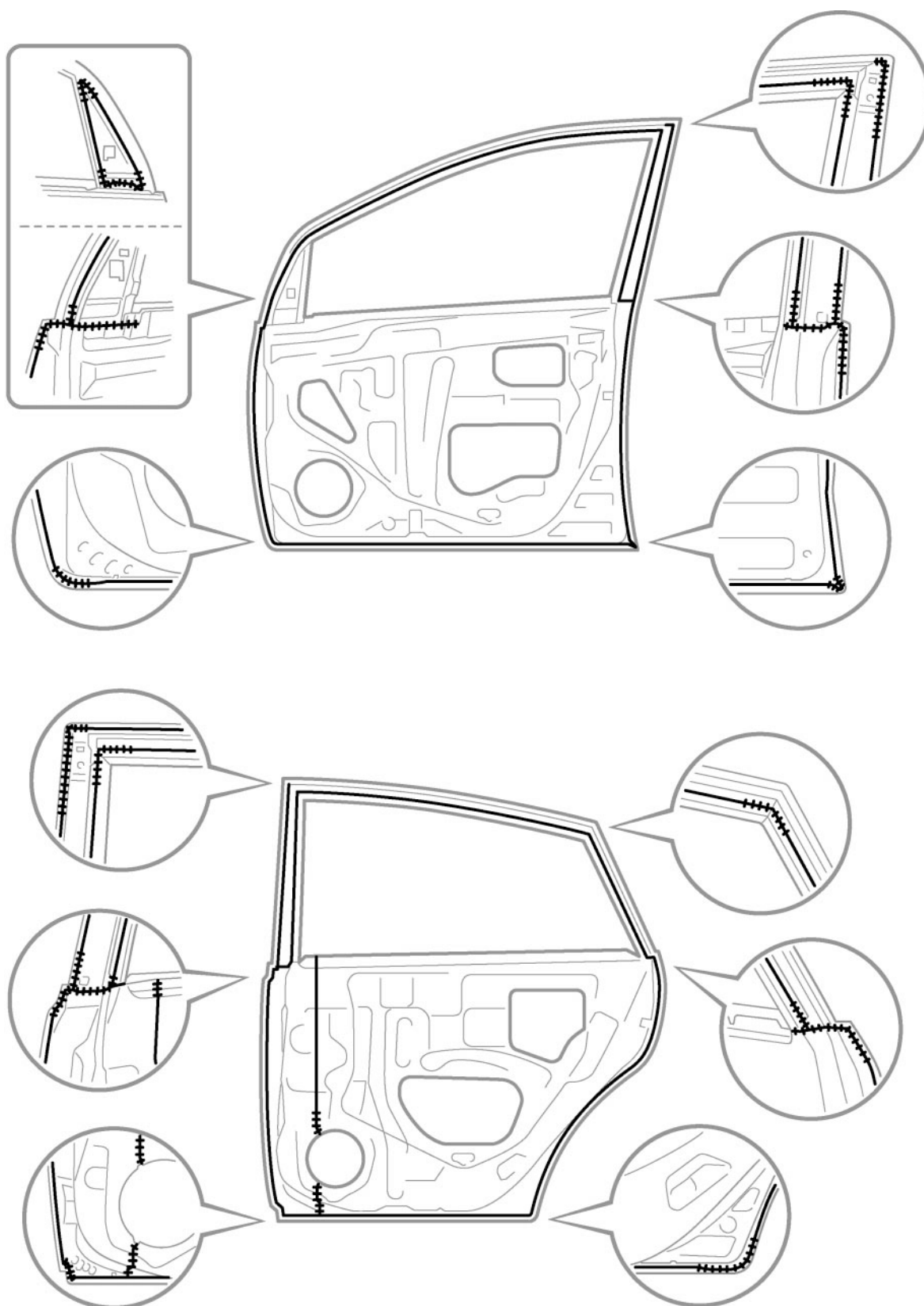

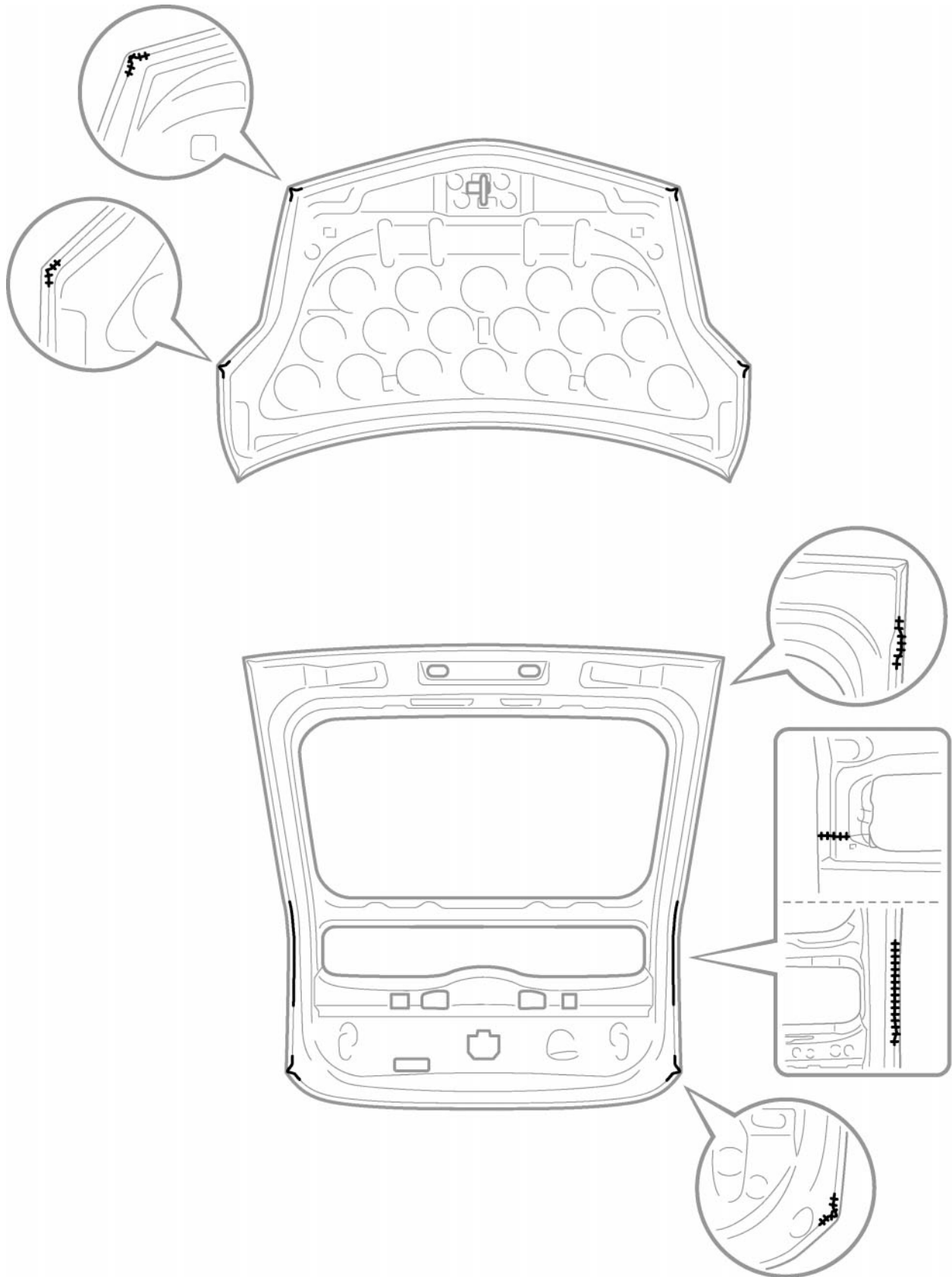

FOAMED MATERIAL APPLICATION AREAS

The sections shown in the figure below are filled with foamed material to provide noise insulation. After repairing these sections or their peripheries, refill with foamed materials

HINT:

- 1) Use the service holes located on the reverse side of the body panel to refill with foamed materials.
- 2) When handling foamed material, follow the directions of the material's manufacturer.

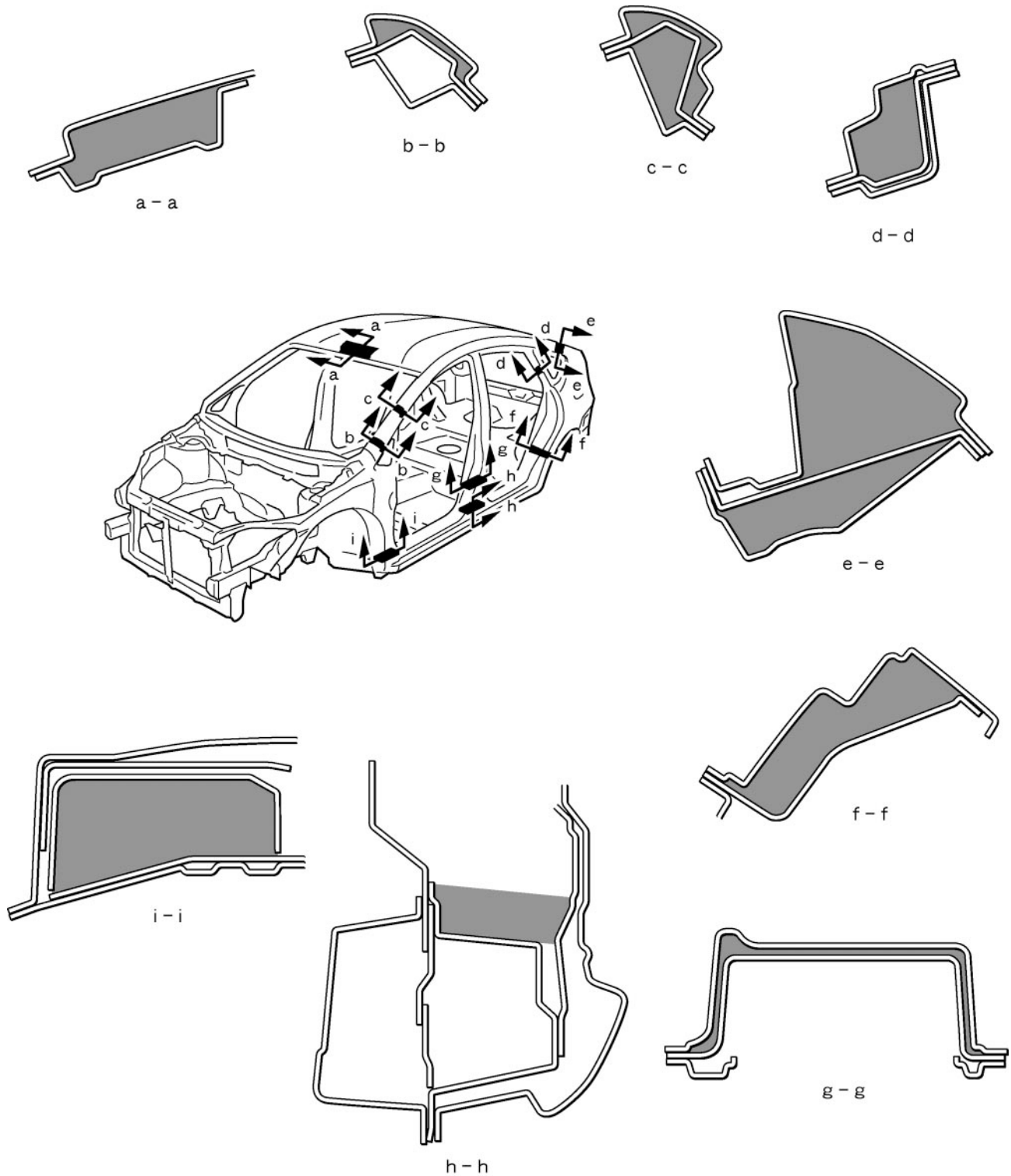

BODY PANEL ANTI-RUST AGENT (WAX) APPLICATION AREAS

HINT:

- 1) Whenever adjusting the doors and hoods, apply anti-rust agent (wax) around the hinges.
- 2) Even if partially repairing a part, apply anti-rust agent (wax) over the entire application area of the part.
- 3) Wipe off the anti-rust agent immediately with a rag soaked in a grease, wax and silicone remover, if accidentally applied to other areas.

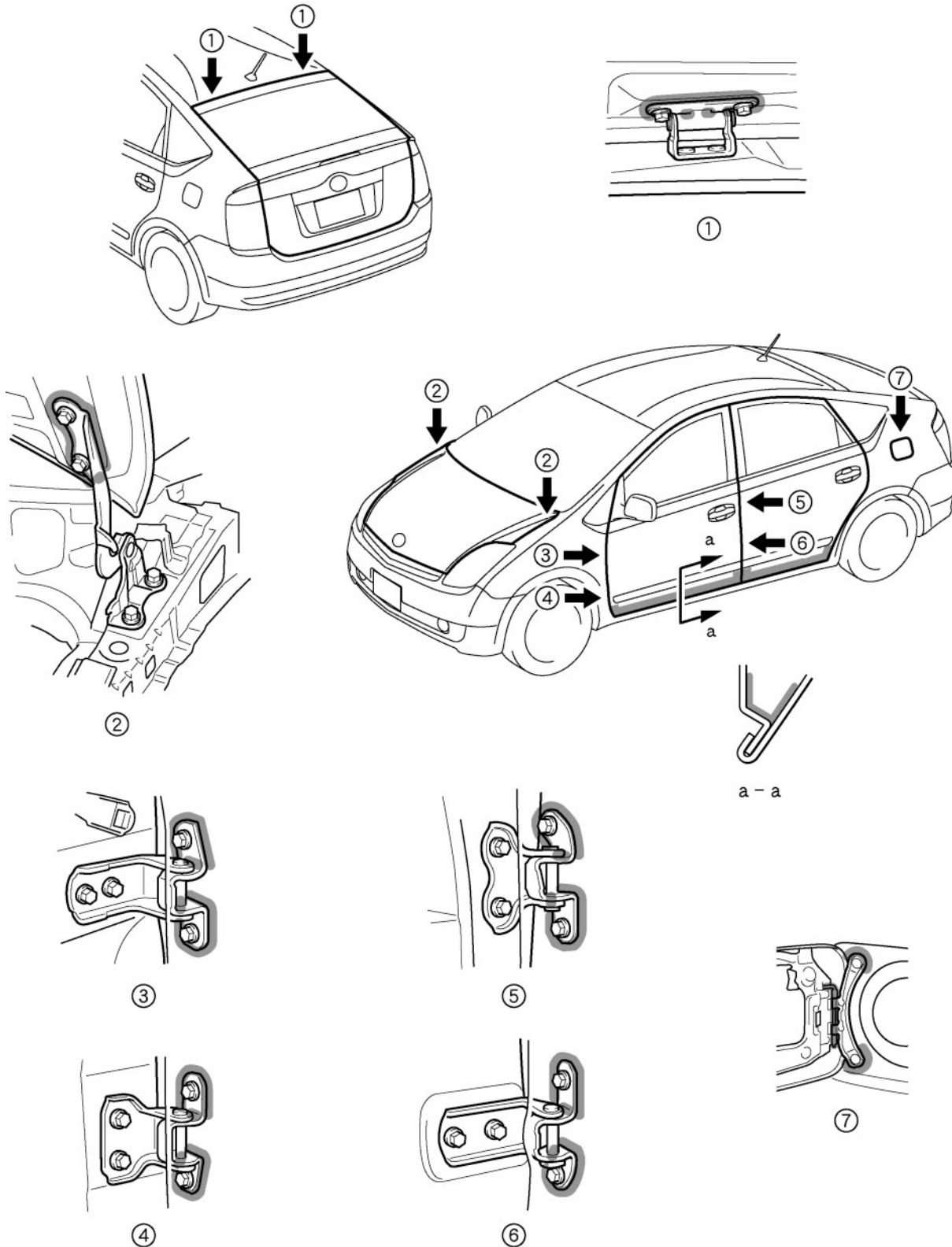



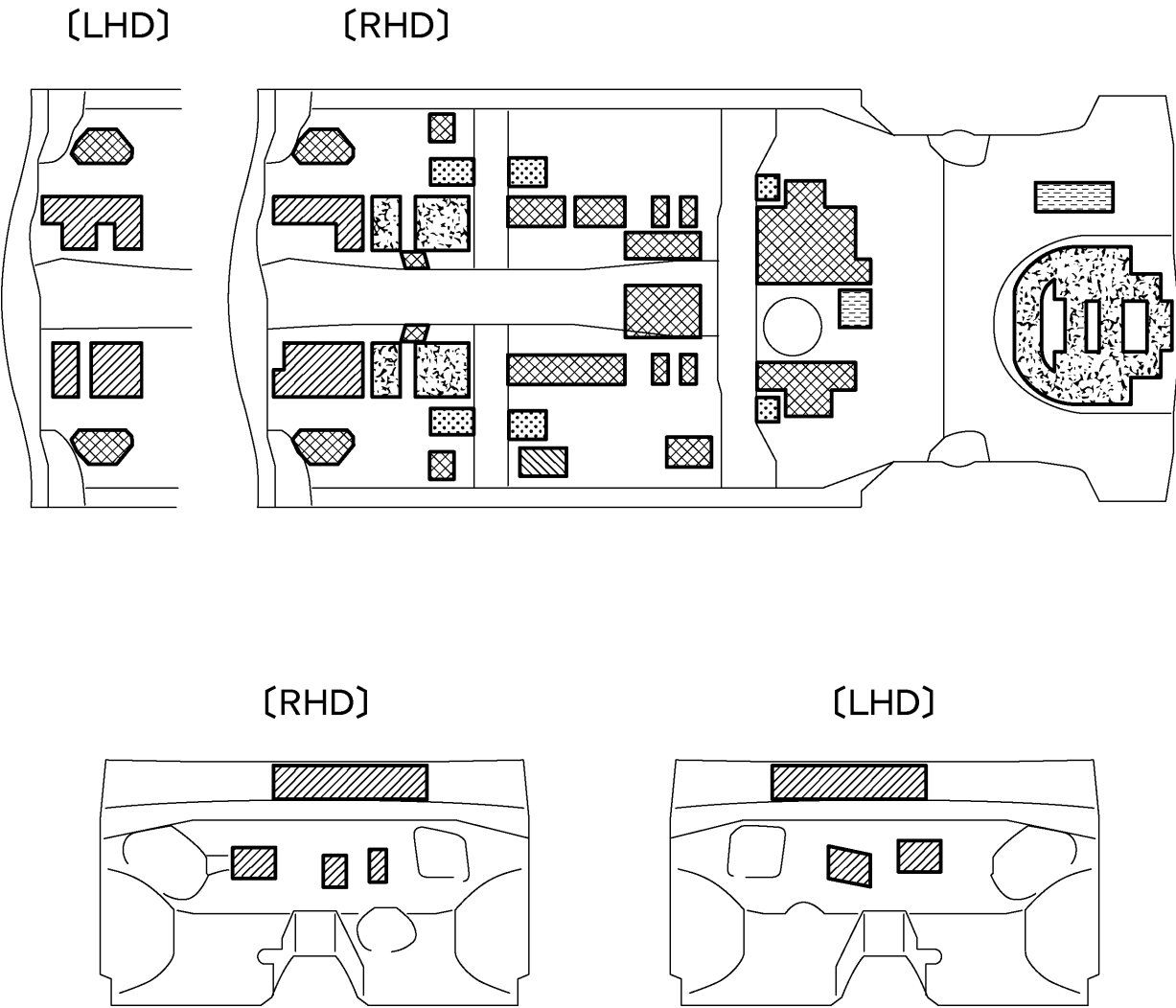



SILENCER SHEET INSTALLATION AREAS



F16109

Thickness of Silencer Sheet

	1.2mm (0.047in.)		2.0mm (0.079in.)		3.0mm (0.118in.)
	3.5mm (0.138in.)		4.8mm (0.189in.)		6.0mm (0.236in.)

BODY PANEL ANTI-CHIPPING PAINT APPLICATION AREAS

HINT:

- 1) Anti-chipping paint should be applied to some areas before the second coat and to others after the top coat.
- 2) If other areas are accidentally coated, wipe off the paint immediately with a rag soaked in grease, wax and silicone remover.

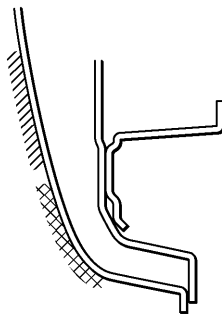
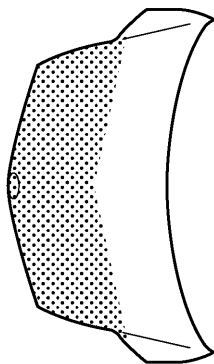
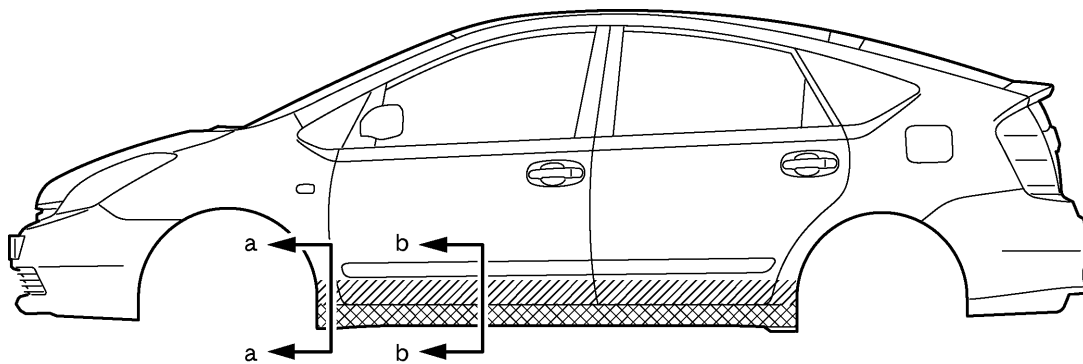

a - a

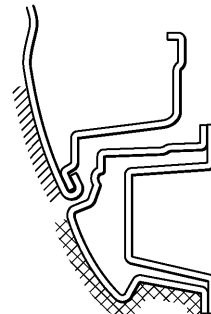

b - b

F16110



PVC



Urethan



Soft - Chip