

<b>Last Modified:</b> 5-3-2010	6.4 A	<b>From:</b> 200904
<b>Model Year:</b> 2010	<b>Model:</b> Prius	<b>Doc ID:</b> RM0000033RT01KX
<b>Title:</b> STEERING COLUMN: STEERING WHEEL: REMOVAL (2010 Prius)		

## **REMOVAL**

### **CAUTION:**

Some of these service operations affect the SRS airbag system. Read the precautionary notices concerning the SRS airbag system before servicing [INFO](#).

### **1. PRECAUTION**

#### **NOTICE:**

Be sure to read Precaution thoroughly before servicing [INFO](#).

### **2. ALIGN FRONT WHEELS FACING STRAIGHT AHEAD**

### **3. REMOVE STEERING PAD**

#### **HINT:**

Refer to the instructions for Removal of the steering pad [INFO](#).

### **4. REMOVE STEERING WHEEL ASSEMBLY**

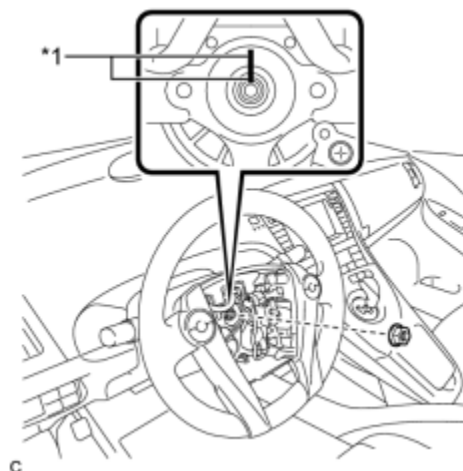

(a) Remove the steering wheel assembly set nut.

#### **Text in Illustration**

\*1

Matchmark

(b) Put matchmarks on the steering wheel assembly and steering main shaft.

(c) Disconnect the connectors from the spiral cable.

(d) Using SST, remove the steering wheel assembly.

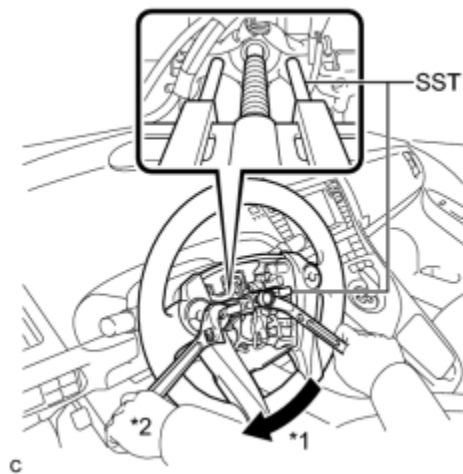

### Text in Illustration

*1	Turn
*2	Hold

#### SST: 09950-50013

09951-05010

09952-05010

09953-05020

09955-04071

#### NOTICE:

Apply a small amount of grease to the threads and tip of SST (09953-05020) before use.

## 5. REMOVE STEERING SHAKE DAMPER



(a) Remove the 2 screws and steering shake damper from the steering wheel assembly.

## 6. REMOVE STEERING PAD SWITCH ASSEMBLY

INFO

## 7. REMOVE CRUISE CONTROL MAIN SWITCH (w/ Cruise Control System)

INFO

## 8. REMOVE CRUISE CONTROL SWITCH WIRE (w/ Cruise Control System)

## 9. REMOVE LOWER STEERING WHEEL BOSS COVER

(a) Disengage the 2 pins and 4 claws to remove the lower steering wheel boss cover from the steering wheel sub-assembly.

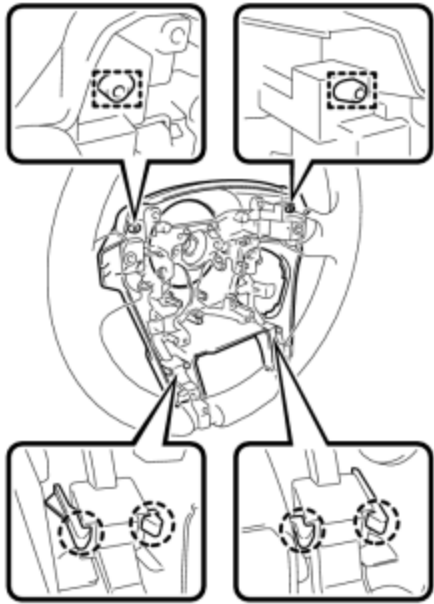

C

