

Noise from Auxiliary Port with External Device

Service Category Audio/Visual/Telematics

Section Audio/Video

Market USA

Toyota Supports
ASE Certification 

Applicability

YEAR(S)	MODEL(S)	ADDITIONAL INFORMATION
2006 – 2008	4Runner, Prius, RAV4	
2007	Camry, Camry HV, FJ Cruiser, Yaris	
2007 – 2008	Solara	

TSB SUPERSESSION NOTICE

The information contained in this TSB supersedes TSB No. AU004-07.

- Applicability has been updated to include 2008 model year 4Runner, Prius, RAV4, and Solara.
- Parts Information has been updated to include a clarifying illustration.

TSB No. AU004-07 is Obsolete and any printed versions should be discarded. Be sure to review the entire content of this service bulletin before proceeding.

Introduction

Some customers may notice noise in the auxiliary mode of their audio system when using an MP3 player or other external audio source connected to the 12V power port of the vehicle. An improved auxiliary port and in-line filter has been developed to improve this condition. Use the repair procedure below to install the new in-line filter and auxiliary port.

Required Tools & Equipment

SPECIAL SERVICE TOOLS (SST'S)	PART NUMBER	QTY
Plastic Pry Tool Set*	00002-06000-01	1

* Essential SST.

NOTE

Additional SSTs may be ordered by calling SPX/OTC at 1-800-933-8335.

Noise from Auxiliary Port with External Device

Warranty Information

OP CODE	DESCRIPTION	MODEL	TIME	OFP	T1	T2
AU7002	R & R Stereo Adapter Assembly	4Runner	0.3	86190-##010	91	99
		Camry (CBU)	0.2			
		Camry (NAP)	0.2			
		Camry HV (NAP)	0.2			
		FJ Cruiser	0.2			
		Prius	0.3			
		RAV4	0.4			
		Solara	0.2			
		Yaris Hatchback	0.2			
		Yaris Sedan	0.2			
Combo A	Install In-line Filter & Adapter Assembly	ALL	0.1			

APPLICABLE WARRANTY

- This repair is covered under the Toyota Comprehensive Warranty. This warranty is in effect for 36 months or 36,000 miles, whichever occurs first, from the vehicle's in-service date.
- Warranty application is limited to correction of a problem based upon a customer's specific complaint.

Noise from Auxiliary Port with External Device

Parts Information

Figure 1.

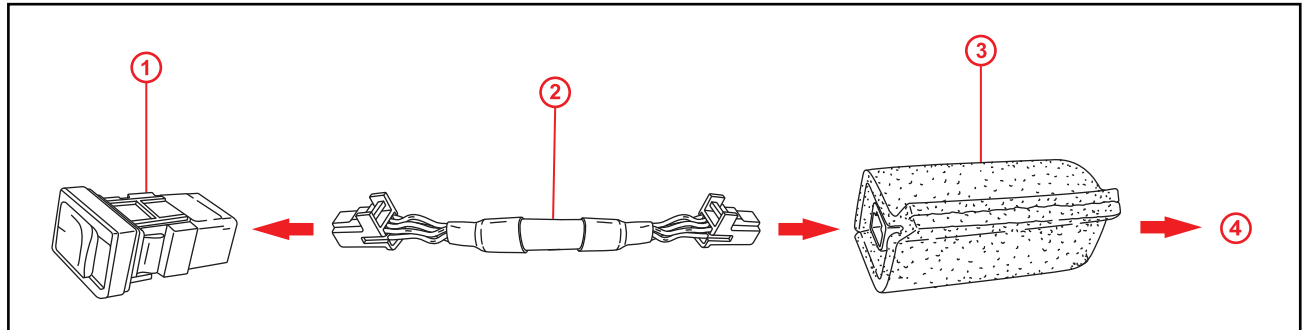

1	Adapter Assembly, Stereo (Mini Jack)
2	Wire, Condenser (Wire Harness)

3	Condenser (Noise Filter)
4	To Existing Vehicle Wire Harness (4P)

ITEM	MODEL	PREVIOUS PART NUMBER	CURRENT PART NUMBER	PART NAME	QTY
1	4Runner	86190-53010	86190-48010	Adapter Assembly, Stereo (Mini Jack)	1
	Camry (CBU)				1
	Camry (NAP)	86190-06010			1
	Camry HV (CBU)	86190-53010			1
	Camry HV (NAP)	86190-06010			1
	FJ Cruiser	86190-53010			1
	Prius				1
	RAV4				1
	Solara	86190-0C010	86190-12020		1
	Yaris Hatchback	86190-52010			1
	Yaris Sedan	86190-53010	86190-48010		1
2	All	N/A	86237-33010	Wire, Condenser (Wire Harness)	1
3	All	N/A	86516-33020	Condenser (Noise Filter)	1

NOTE

Items 1, 2, and 3 are needed for all vehicles. Item 1, *Adapter Assembly, Stereo (Mini Jack)*, **MUST** be ordered according to specific model. Items 2 and 3 are the same for all models listed.

Noise from Auxiliary Port with External Device

Repair Procedure

1. Remove the existing auxiliary port terminal from the vehicle.

Refer to the Technical Information System (TIS):

- [2006](#), [2007](#), or [2008](#) model year 4Runner Repair Manual, *Audio/Visual/Telematics – Audio/Video – “Audio/Visual: Audio Terminal: Removal”*
- 2007 model year [Camry](#) or [Camry HV](#) Repair Manual, *Audio/Visual/Telematics – Audio/Video – “Audio/Visual: Audio Terminal: Removal”*
- 2007 model year [FJ Cruiser](#) or [Yaris](#) Repair Manual, *Audio/Visual/Telematics – Audio/Video – “Audio/Visual: Stereo Jack Adapter Assembly: Removal”*
- [2006](#), [2007](#), or [2008](#) model year Prius Repair Manual, *Vehicle Interior – Interior Panels/Trim – “Instrument Panel: Rear Console Box: Removal”*
- [2006](#), [2007](#), or [2008](#) model year RAV4 Repair Manual, *Vehicle Interior – Interior Panels/Trim – “Instrument Panel: Lower Instrument Panel: Removal”*
- [2007](#) or [2008](#) Solara Repair Manual, *Audio/Visual/Telematics – Audio/Video – “Audio/Visual: Audio Terminal: Removal”*

Figure 2.

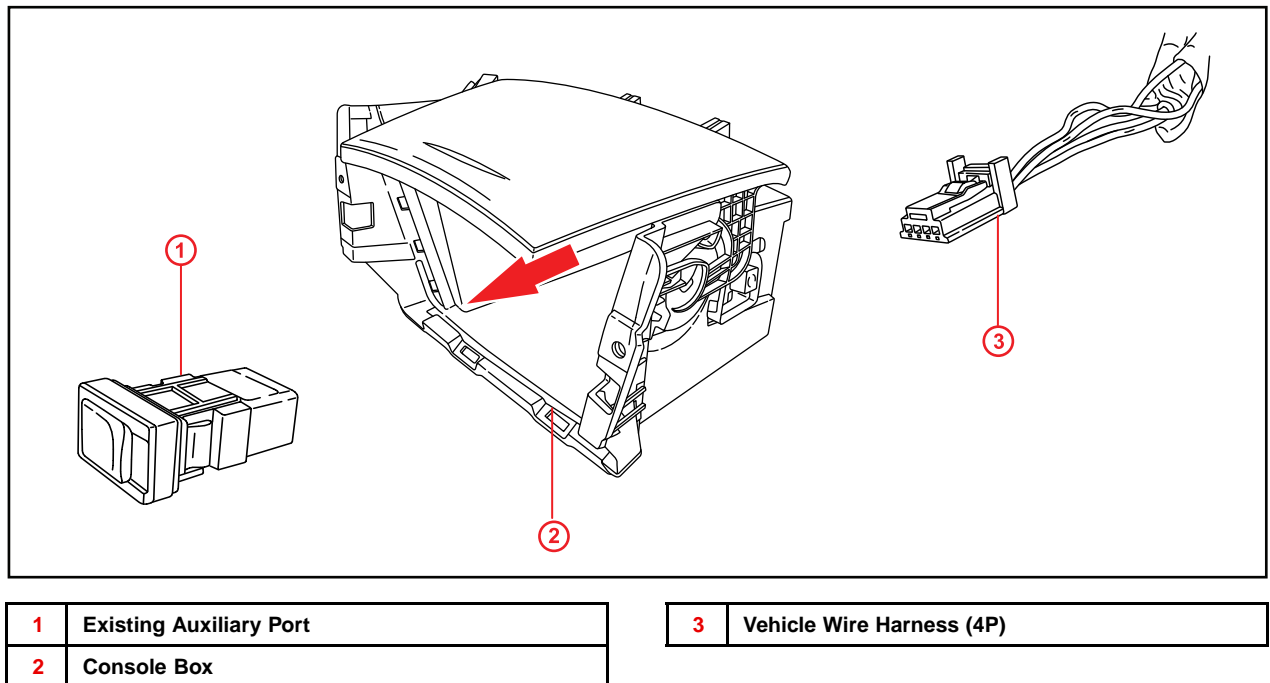

Noise from Auxiliary Port with External Device

Repair Procedure (Continued)

2. Install the revised auxiliary port, wire harness, and noise filter.

Tape the noise filter to the back side of the trim panel near the auxiliary port ensuring the filter does NOT touch other parts or the wiring harnesses in the vehicle.

NOTE

Steps A – D are generic installation instructions. The 2007 model year Camry installation is provided as an example.

- A. Connect the vehicle wire connector (4P) into the filter, and connect the filter wire connector (8P) into the filter.

Figure 3.

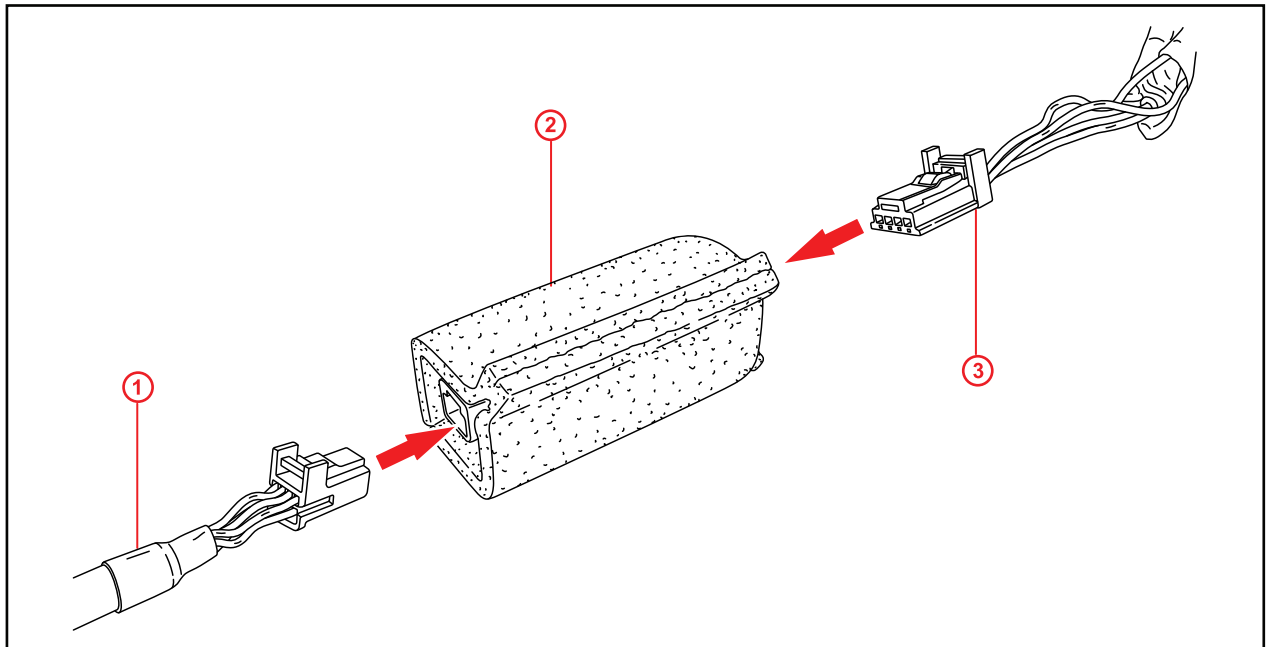

1	Filter Wire (8P)
2	Filter

3	Vehicle Wire Harness (4P)
---	---------------------------

Noise from Auxiliary Port with External Device

Repair Procedure (Continued)

B. Secure the filter to the vehicle wire harness using wire ties.

Figure 4.

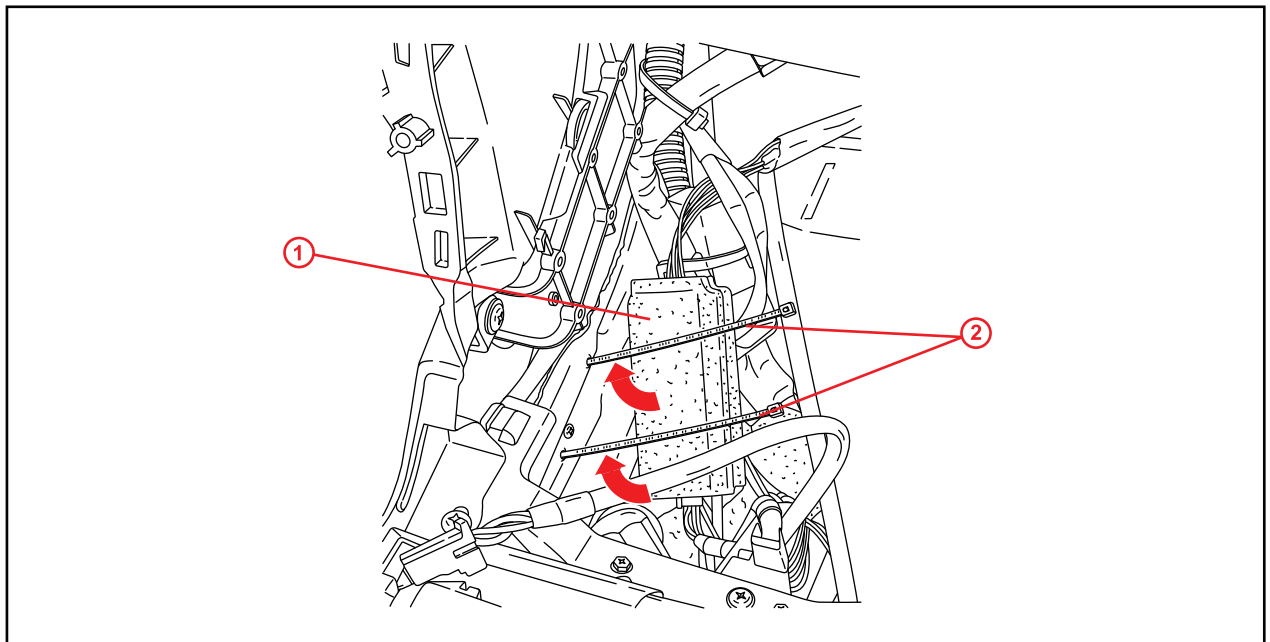

1	Filter
----------	---------------

2	Wire Ties (x2)
----------	-----------------------

C. Install the NEW auxiliary port to the console box.

Figure 5.

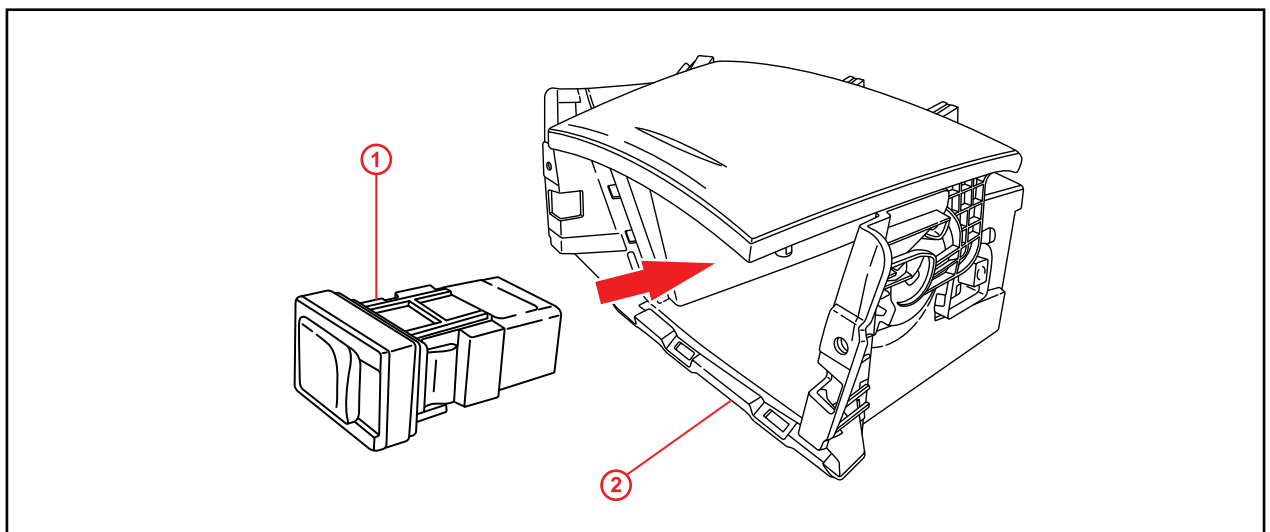

1	Auxiliary Port
----------	-----------------------

2	Console Box or Center Console Box
----------	--

Noise from Auxiliary Port with External Device

Repair Procedure (Continued)

D. Connect the filter wire connector (8P) into the NEW auxiliary port.

Figure 6.

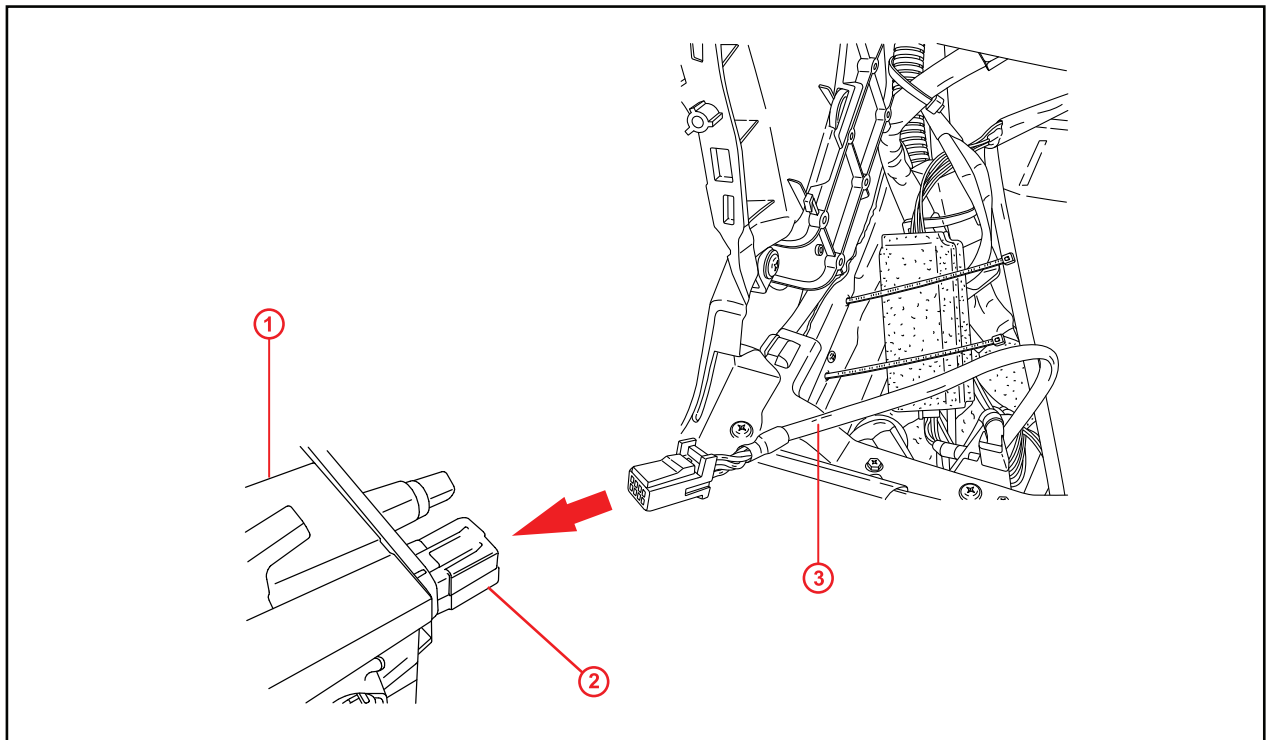

1	Console Box
2	Auxiliary Port

3	Filter Wire
----------	-------------

3. Reassemble the vehicle in reverse order of disassembly.
4. Verify proper operation and that NO noise persists in the auxiliary mode of the audio system.